

# Landscape Management Plan



**University of Salford Landscape Management Plan**

**2020/21-2024/25**



University of  
**Salford**  
MANCHESTER

# Table of Contents

<b>Table of Contents.....</b>	<b>2</b>
<b>Introduction and Background .....</b>	<b>2</b>
Introduction .....	2
Strategic context .....	2
Site description and current use .....	4
History of the site.....	12
<b>A Welcoming Place .....</b>	<b>15</b>
Good and safe access.....	15
Signage .....	18
Equal access for all .....	19
<b>Healthy, Safe and Secure.....</b>	<b>20</b>
Appropriate provision of quality facilities and equipment.....	20
Safe equipment and facilities.....	21
Personal security .....	22
Control of dogs/dog fouling .....	22
<b>Well Maintained and Clean .....</b>	<b>23</b>
Litter and waste management.....	23
Maintenance planning .....	24
Horticultural maintenance.....	24
Arboriculture and Woodland Maintenance.....	25
Building and Infrastructure Maintenance.....	25
Equipment Maintenance .....	25
<b>Environmental Management.....</b>	<b>26</b>
Managing environmental impact.....	26
Waste minimisation .....	27
Chemical Use.....	27
Peat Use .....	28
Climate change adaptation strategies and water management .....	28
<b>Biodiversity, Landscape and Heritage .....</b>	<b>30</b>
Management of natural features, wild fauna and flora .....	30
Conservation of landscape features .....	36
Conservation of buildings and structures.....	39
<b>Community Involvement.....</b>	<b>42</b>
Community involvement in management and development.....	42
Appropriate provision for the community.....	43

<b>Marketing and Communication .....</b>	<b>49</b>
<b>Management .....</b>	<b>51</b>
<b>Action Plan .....</b>	<b>51</b>
<b>Green Flag Award Criterium .....</b>	<b>51</b>
<b>Area Specific Biodiversity Plans .....</b>	<b>55</b>
<b>Appendix 1 – Closed actions .....</b>	<b>58</b>
<b>Appendix 2 – Links and screenshots.....</b>	<b>61</b>

Document Control Information			
Author	Summary of changes	Version	Authorised & Date
Z.Pegg / E.Goodchild	Annual review and update of the document	V7.0	R. Bennett, Associate Director of Sustainability, January 2025
M. Strzelecka / E.Goodchild	Review of the document and update of action plan	V6.0	R. Bennett, Assistant Director of Sustainability, January 2024
M. Strzelecka	Updated content and action plan	V5.0	R. Bennett, Assistant Director of Sustainability, 27 <sup>th</sup> January 2023
M. Strzelecka	Updated content and action plan	V4.0	R. Bennett, Head of Environmental Sustainability, 17 <sup>th</sup> February 2022
R. Bennett	Updated Action Plan – CV-19 impacts	V3.0	Environmental Projects Board, January 2021
N. Mowl	Updated to five-year version (2020/21-2024/25)	V2.0	Environmental Projects Board, August 2020
N. Mowl	Creation of document (2019 version)	V1.0	Chris Large, Deputy Director of Estates & Facilities, member of Environmental Projects Board, January 2019

---

# Introduction and Background

## Introduction

The University of Salford is home to around 26,000 students and 2,500 staff and is made up of three campuses: Peel Park, Frederick Road and MediaCityUK. This Landscape Management Plan (LMP) focuses on the Peel Park, Frederick Road and Crescent campuses, which are located 1 mile west of Manchester city centre. The University celebrated its 50<sup>th</sup> anniversary in 2017 so is relatively young, but it is still developing, and it is at the heart of a £800 million regeneration scheme of the local area.

This LMP has been produced by the Environmental Sustainability Team and Grounds Maintenance Team, in consultation with various other departments across the University. The aim of the document is to provide a clear outline of what the University is currently doing to manage its green. It provides guidance for the day-to-day management of the site as well as longer term strategies for the site's maintenance and development. The Green Flag Award provides a useful framework to assess how well the outside spaces on campus are currently managed and identify opportunities for improvement. We first achieved Green Flag Award status in 2019 and we have maintained it every year since.

## Strategic context

Environmental and social sustainability form two pillars of the [University's Strategy 2022-27](#). The University's sustainability vision is that 'by embedding sustainability in all aspects of University life, we will enable our university community to create impactful positive change for society and environment.' Having a green and biodiverse campus that promotes sustainability is therefore a key enabler.

Salford City Council (SCC) and the University of Salford are working in partnership on a [Campus Connectivity Plan](#) for the University and surrounding city districts. It includes a Landscape strategy that puts an emphasis on engaging Peel Park with the University. Aspects include extending the park through the campus, creating a biophilic campus and fostering wellbeing throughout the public realm. The Campus Connectivity Plan also aims to deliver a net gain in biodiversity through our Sustainable Construction Policy and provide high quality green spaces to support physical and mental wellbeing of our community by enabling healthy lifestyles and outdoor activities including commuting, exercising, and socialising. The new buildings will inevitably put pressure on our outside spaces, but as part of the plan we will look for opportunities for new green spaces in our urban environment to promote learning, wellbeing and healthy lifestyles. An extra 1000 trees along the A6 and around campus are planned to be planted, alongside introduction of a network of 'rain gardens' to capture and redistribute surface run-off.

During 2024 a new Public Realm Board was established which aims to enhance the campus by addressing the spaces between buildings and integrating public realm features, pedestrian and cycle routes, service access, and greening efforts. A Landscape and Biodiversity Workstream has also been established as a sub-team to this board, to ensure biodiversity related issues are addressed as part of the wider project and to generally enhance biodiversity on campus.

The Estates & Facilities [Environmental Sustainability Policy](#) includes commitments to protect and enhance the natural habitats and biodiversity on the University estate, to embed care for the environment in the culture of our Estates & Facilities Division, and to empower and motivate the

---

whole University community to support our policy and strategy through appropriate education and communication. The Landscape Management Plan and associated actions support the achievement of these commitments.

## Site description and current use

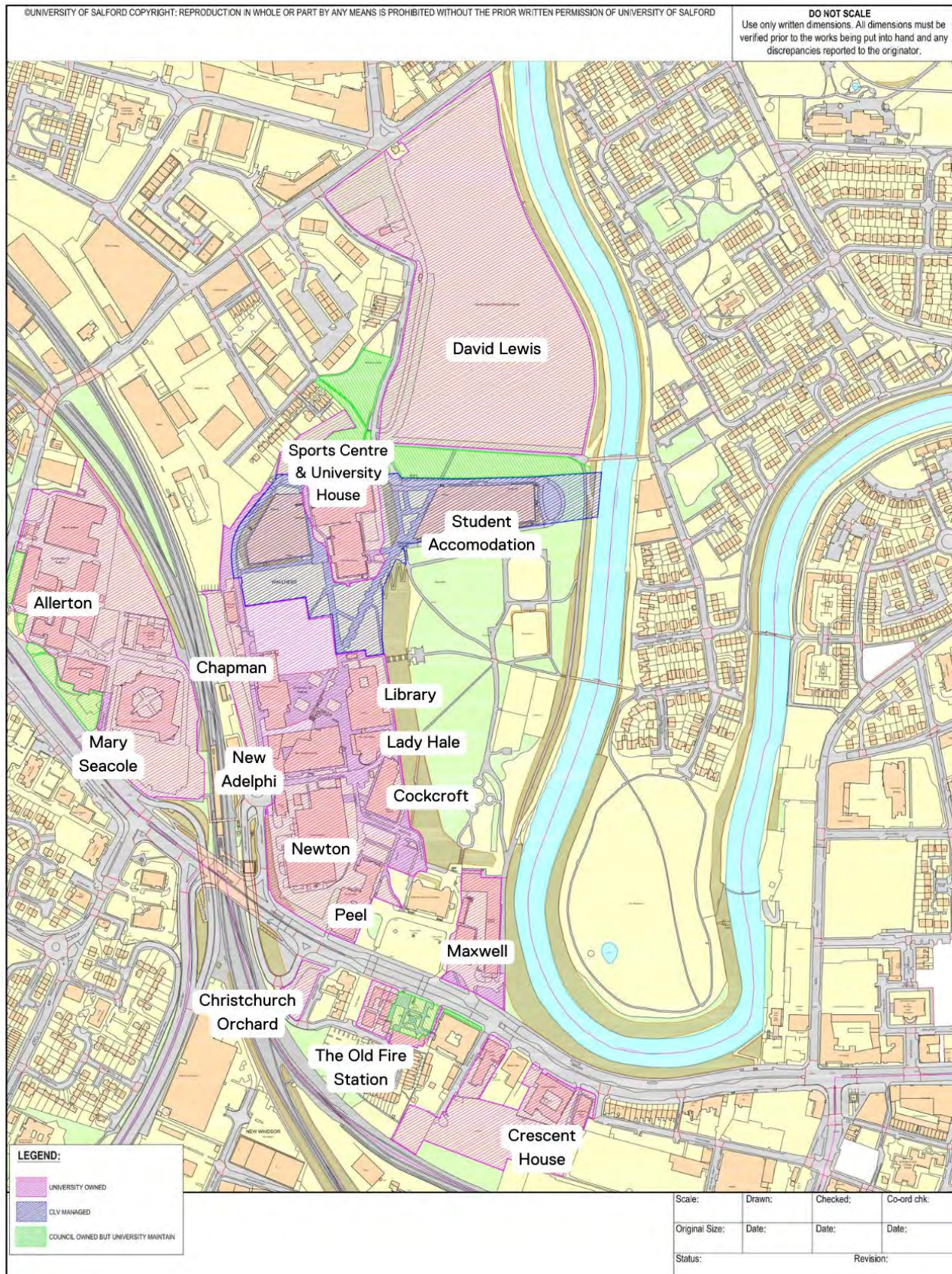

Figure 1: Map showing University owned and managed land that is included in the LMP (pink), CLV managed areas (blue) and areas that are owned by Salford City Council (SCC) but are maintained by the University (green). Areas with no shading are owned, managed, and maintained by the SCC.

The University of Salford is a public open-access site, integrated with Salford City Council (SCC) areas, land owned by the University but managed by Campus Living Villages (CLV), and University owned and managed land. Figure 1 shows these different areas and The Landscape Management Plan is restricted to the University owned and managed areas, highlighted in pink. This comprises all the University buildings, car parks, Christchurch Orchard, and David Lewis playing fields. CLV manage the land around Peel and Delaney accommodation and the green space between University House and Clifford Whitworth. SCC own land in front of The Old Fire Station, most of the woodland adjacent to Wallness Lane and stretching down to the River Irwell along University Road, and sections of shrubbery on Frederick Road campus.

The site is managed and maintained by the Grounds Maintenance Team, which includes the Landscape Team Leader and five gardeners (including One Hard Landscaper), all trained to a minimum of Level 2 NVQ in Horticulture.

The University has a prominent frontage on the A6 leading into Manchester, next to Peel Park. Part of the Peel Park campus sits within a conservation area (see the *Biodiversity, Landscape and Heritage* section for more information). The site includes nationally and locally listed buildings, as well as high-tech newer facilities such as the New Adelphi building and the School of Science, Engineering and Environment (SEE) building.

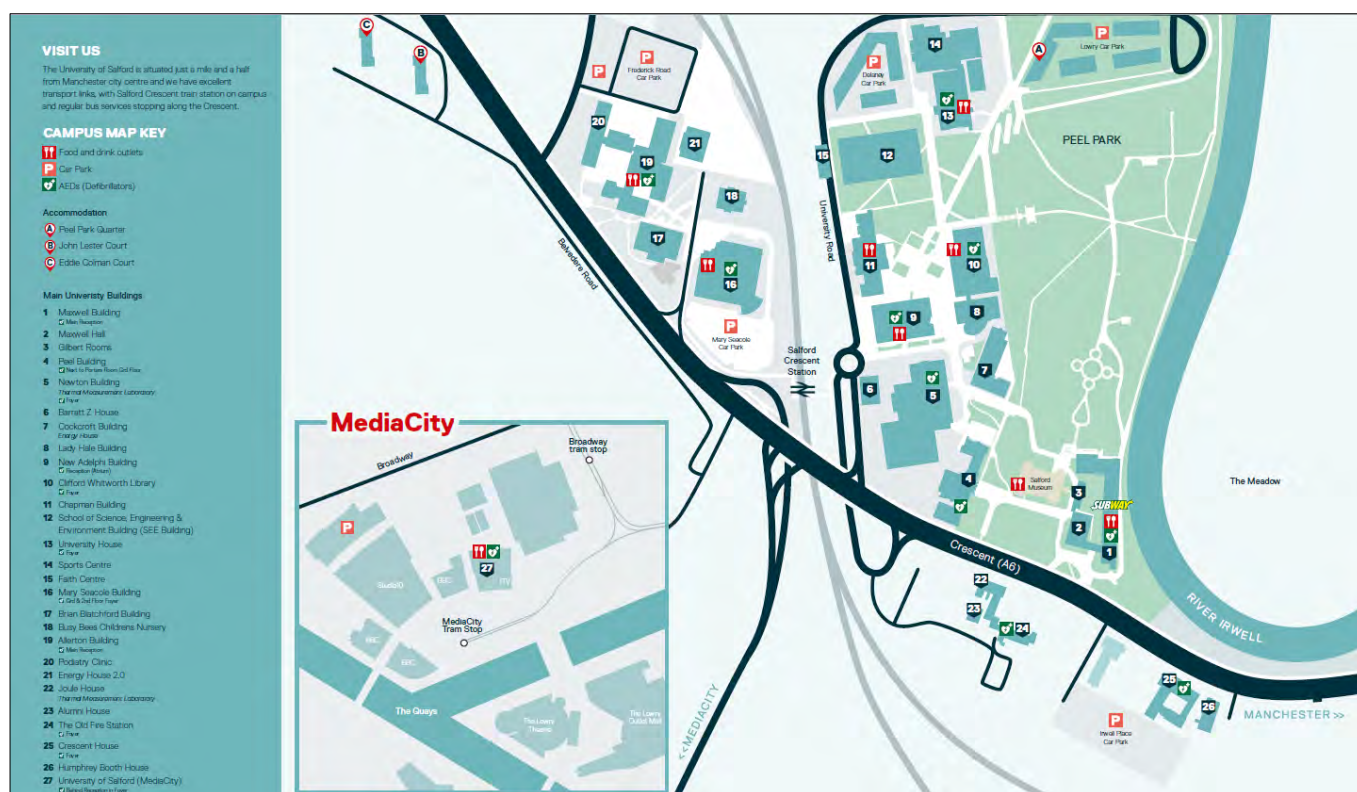

Figure 2: Campus map (full size available [on the website](#)).

## Crescent Campus

On the south side of the A6, Fire Station Square contains a fountain, a Grade II listed phone box and an old fire station (locally listed), which has been repurposed into university offices. The Old Fire Station has a small garden with an olive tree that was planted to celebrate the first Green Impact awards in 2014, as well as a fruiting fig tree. This area is a combination of University and SCC owned areas, but all areas are maintained by the University, apart from the trees. Further along this side of the A6, in terms of well used outside spaces, there is a courtyard in the middle of Crescent House; a light and airy space for staff, students and visitors to enjoy and relax with a variety of plants and outdoor furniture. In the opposite direction, on the far edge of the conservation area, is a site that is used as a public orchard and community space, known as Christchurch Orchard.

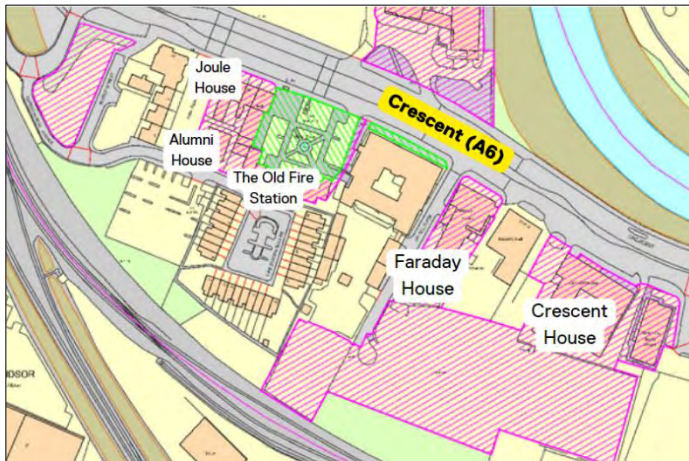

Figure 3: Map showing University owned and managed land (pink) and areas owned by Salford City Council but maintained by the University (green) on Crescent campus

## Peel Park Campus

On the opposite side of the A6 is the main Peel Park campus. The main pedestrian entrance is in front of Maxwell building, next to a large sculpture of the word Salford. Nearby is Maxwell Hall, which has been previously used as a concert venue for bands such as The Fall, Blondie, and The Charlatans. This sits next to Salford Museum and Art Gallery, which is owned by SCC, as is the land to its front.

The iconic red-brick Peel building can be seen from the A6. This Grade II listed building houses part of the School of Science, Engineering and Environment department and is also used for events such as BBC philharmonic concerts. A pathway between Peel building and the Museum leads into the centre of campus, via the Willow Memorial Garden.



Figure 4: Peel Building

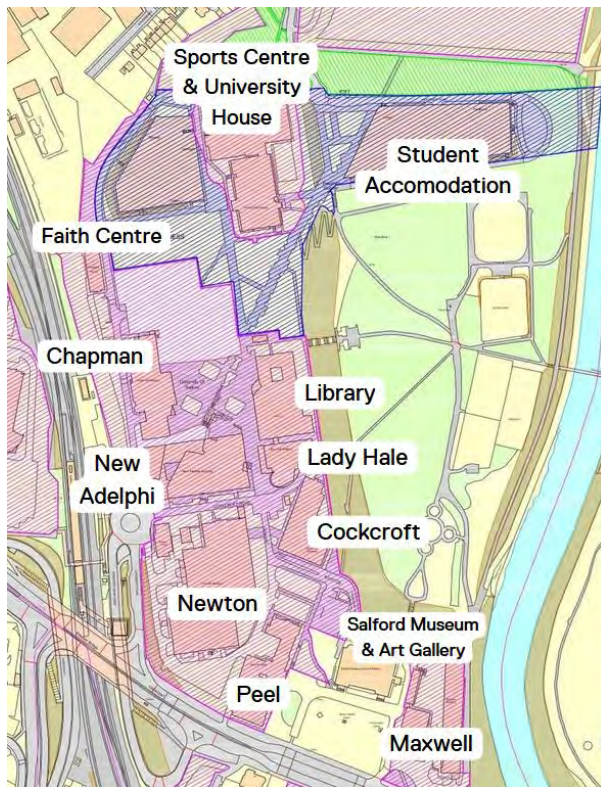

Figure 5: Map showing University owned and managed land (pink) in the central part of the campus

Cockcroft building contains our award-winning research facility, Energy House, in addition to teaching labs.

Moving further through the campus on the Broadwalk, which acts as a spine through the main campus, there is Chapman Square which contains a climbing sculpture, celebrating Friedrich Engel (see Figure 22 later in the report), as well as an amphitheatre.



Figure 6: Chapman Square

This is the heart of the Peel Park campus, and many events take place in this area including Welcome Week and Students' Union events. There are raised lawns and trees with seating around them and further along there are green spaces, used for events and gatherings. The Clifford Whitworth Library also contains a small courtyard with planters, benches, bird bath and bird feeders. The newest feature

is a legacy garden, a sculpture with memorial plaques engraved into glass on individual plinths, to commemorate those who have supported the University.

The Broadwalk extends off to the right-hand side towards the halls of residence, which passes through green spaces with a variety of trees and the back entrance of University House, where outdoor seating is situated. Some of this outside space is managed by Campus Living Villages (CLV), as shown on Figure 8.

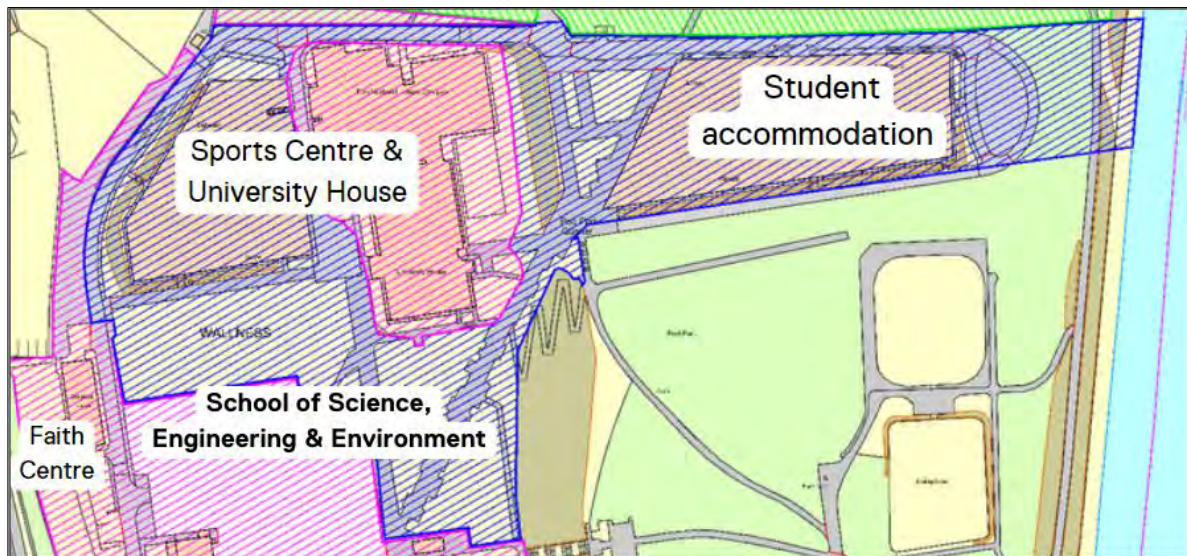

Figure 7: Map showing University owned and managed land (pink) and CLV managed areas (blue) in the north of the Peel Park campus.

Following the Broadwalk straight on from Chapman Square and past University House, you reach the Sports Centre, which is open to the public and has an outdoor gym at the entrance. Further north and within the conservation area there is the University's recreation ground, known as the David Lewis Playing Fields, which includes a 3G pitch and open green space. The woodland continues around the perimeter of the playing fields, and we have worked with City of Trees to plant approximately 800 tree whips on the south and west areas of the Playing Fields which in 2024 has matured to a natural area with a wide range of plant biodiversity present (see biodiversity section for more information and photographs).

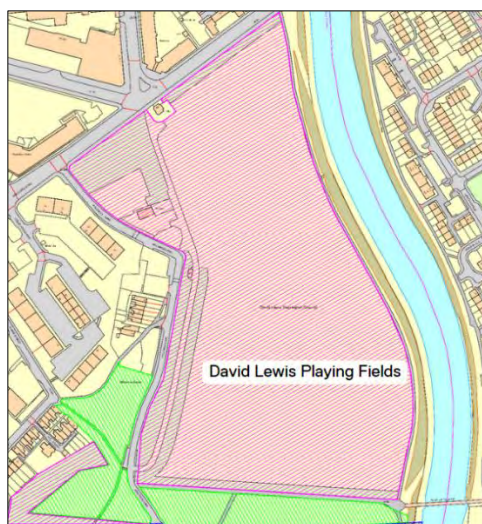

Figure 4: Map showing University managed land (pink), and the woodland areas that are owned by Salford City Council but maintained by the University (green) around the David Lewis Playing Fields.

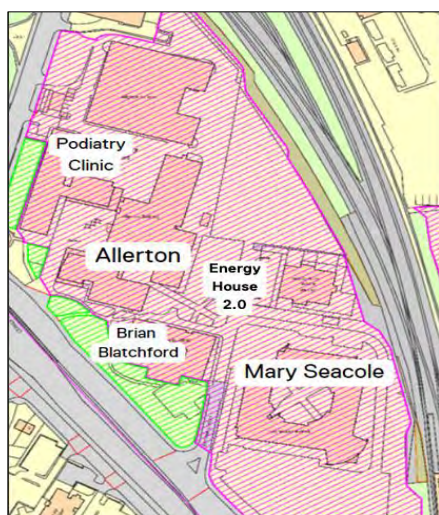

Figure 5: Map showing University owned and managed land (pink) and areas owned by SCC but maintained by the University (green) on the Frederick Road campus.

---

## Frederick Road Campus

Across the railway track is the Frederick Road campus usually accessed via the back of Mary Seacole building, with an accessible passage to improve access between the two campuses. However, this route is currently closed for the construction of the new Health Clinic Building and will re-open upon completion of the building in autumn 2026. Access is currently off the A6 at the front of the campus.

This campus has a green frontage with a variety of trees, scrubs, and lawns, which are owned by SCC but maintained by the University.



*Figure 6: Accessible Passage between campuses*

One of the main entrances to this campus is from Frederick Road, walking through Allerton Square, where you will find three interesting totem sculptures which are Grade II Listed (see figure 43 later in the report). Within this square is the Dementia Garden, part of the Dementia Hub, a community involved project which was opened by Christopher Eccleston. There are two raised beds within the square containing Paper Birch, and a sculpted seating area.



*Figure 7: Mary Seacole Courtyard and Dementia Hub*

Between Allerton building and Mary Seacole is a well-maintained lawn space, with trees and scrubs. To soften the hard landscaped area, raised beds have been installed and around the perimeter of the site is a variety of scrubs and trees which create a green noise barrier between the buildings and the A6. Next to the Allerton building there is now the newly developed [Energy House 2.0](#), which allows the University to expand its research into low carbon housing. The green space next to the building has been preserved and some benches and wastebins were added alongside it to encourage staff and students to spend time outdoors during their breaks.



*Figure 8: Energy House 2.0 with a green space, benches and planters*

In the atrium of Mary Seacole you will find formal lawns, flower beds and raised planters. The garden is managed by the Nursing Service Users and Carers Group who work with staff from the School of Health and Society.

## History of the site

### 19<sup>th</sup> Century

The University of Salford's past is rooted in the great Industrial Revolution of the 19th Century which changed the world. Salford's thriving textile industry was fed by the Manchester Ship Canal which was opened in 1894 and gave the city direct trade access to the sea. The Salford docks brought employment until the latter half of the 20th Century when the old industries went into decline.

Demand for new industrial skills led to the formation of the Pendleton Mechanics Institute in 1850 and the Salford Working Men's College in 1858.

Figure 13 shows the area where the Frederick Road campus is now situated, with the current buildings overlaying a map from 1892. The area in 1892 was full of industry, including glass works, iron works and engine works. Figure 14 shows the area where the Peel Park campus was located in 1892, a large area of which was made up of Wallness Farm, which is also shown in the map from 1909 (Figure 15).



Figure 9: Map of Frederick Road campus from 1892 with current buildings overlaid.

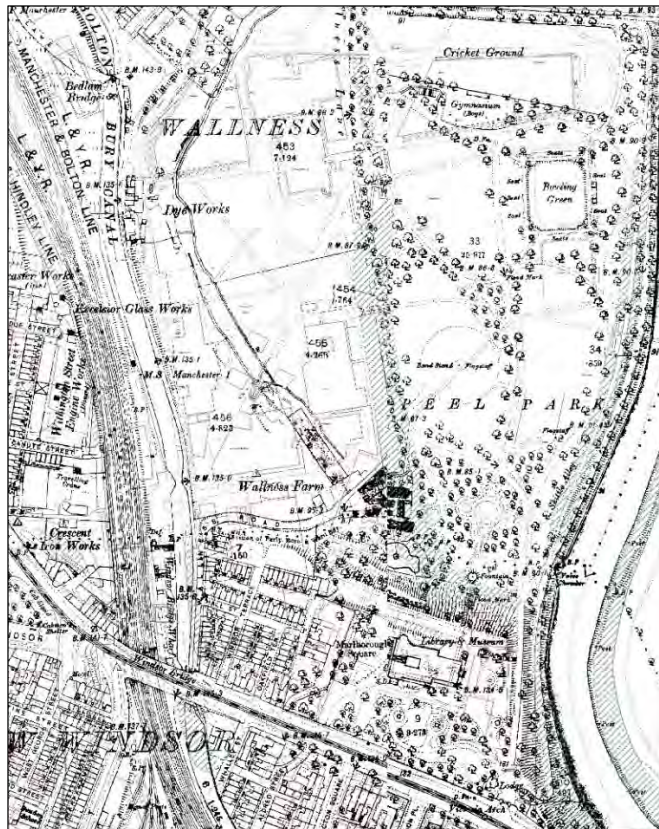

Figure 10: Map of Peel Park campus from 1892 with current buildings overlaid.

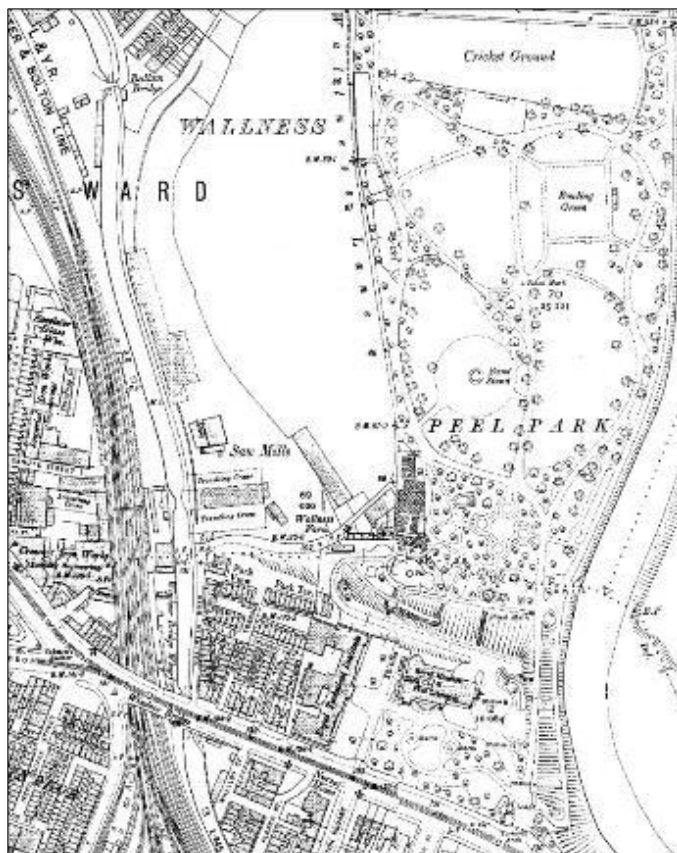

Figure 11: Area where Peel Park campus is situated in 1909.

At the end of the century, the Pendleton Mechanics Institute and the Salford Working Men's College merged to create the Royal Technical Institute, Salford, which was opened by the Duke and Duchess of York (who later became King George V and Queen Mary) in 1896. The statues of Queen Victoria and Prince Albert in front of the Salford Museum and Art Gallery commemorate the royal visit to Salford in 1851. Figure 15 shows the area in 1909 including the Royal Technical Institute, which was situated in what is now called the Peel Building.

## 20<sup>th</sup> Century

In 1921 the Royal Technical Institute was renamed the Royal Technical College, Salford. In 1958 it split into two separate organisations – The Royal College of Advanced Technology and the break-away Peel Park Technical College.

The break-away college became the Peel Park Technical Institute in 1961, the Salford College of Technology in 1970, and then the University College Salford in 1992.

On 10 February 1967, the Royal College of Advanced Technology became the University of Salford when Her Majesty the Queen handed over the Royal Charter.



Figure 12: Peel Park Campus in 1973.

The University College Salford and the University of Salford finally merged into a single institution in 1996 – exactly 100 years after the formation of the original Royal Technical Institute.

The main library is named after Clifford Whitworth, the first Vice-Chancellor of Salford. The first Chancellor was Prince Philip, Duke of Edinburgh, who remained in the post until 1991.

Joule House in Acton Square was the home of prominent physicist James Prescott Joule who gave his name to the unit of energy, and the Working-Class Movement Library is just around the corner.

# A Welcoming Place

## Good and safe access

### Public Transport

The University of Salford Peel Park and Frederick Road campuses can be easily accessed via public transport and are in walking distance (2km) of Manchester City Centre. Salford Crescent train station is situated between the two campuses, with direct services to and from Manchester Airport, Manchester Piccadilly, and Victoria, as well as Blackpool, Bolton, Buxton, Blackburn, Southport, Preston, Lancaster, and Barrow-in-Furness. Inter-city services normally use Manchester Piccadilly, which is about a 10-minute train journey from Salford Crescent.

There are regular bus services, including the number 50 operated by Stagecoach, which travels between Didsbury and MediaCityUK, via Manchester City Centre, Peel Park and Frederick Road campus and Salford Shopping Centre. Staff and students can travel free on the 50 bus between the main and MediaCityUK campuses, by producing their University ID card. You can read more about travelling to the University by public transport [here](#).

### Cycling

Staff and students are encouraged to travel to university by cycling, with seven secure cycle shelters (monitored via CCTV and requiring University ID cards to access) and showers available across the campuses. For details, you can visit our [sustainable travel page](#). For visitors and those without an ID card, there are also Sheffield Stands available. D-locks are sold at a subsidised cost at the Sports Centre and from the Security Team, who also give away high-vis jackets and lights throughout the year. pumps and tools are also located by the cycle shelters. In 2022, we became a [Cycle Friendly Employer](#), accredited by Cycling UK with the Gold Award. National Cycle Network (NCN) Route 6 runs along the east side of Peel Park.



Figure 13: Cycle maintenance station next to a cycle shelter.



Figure 14: One of our secure cycle shelters.

## Safety

Vehicles on site are managed well, particularly in areas shared with pedestrians. Physical barriers are located at the entrance to Peel Park campus next to Gilbert Rooms, which are controlled by the Security Team. There is also a physical barrier at the exit of campus to prevent vehicles coming in the wrong way through the one-way system. A physical barrier is also located adjacent to the Sports Centre which restricts access to the car park outside University House. This car park is for disabled parking only so blue badge holders are permitted access.

Drop bollards are located at other entry points with shared access to restrict vehicles, while providing a more welcoming entrance than a barrier and allowing ease of access for prams, cycles, etc. This includes an automatic rising bollard at the top of Cockcroft Road. This is managed via the Security Team with restricted access times. Guidance on bringing vehicles onto campus is provided to contractors in the Contractor Handbook, and the University also has a Vehicles on Campus procedure and a Parking Policy. To support this policy, there is signage on campus including speed limits shown on Cockcroft Road, as well as other rules of access, such as no reversing without a banksman and restrictions on access to the Broadwalk from vehicles. Restricted access areas do not apply to blue badge holders.

## Accessibility

The University has a strong commitment to equality and inclusive design, so that our campus can be used by everyone. We have worked with AccessAble (formerly DisabledGo) since 2008 to provide trusted accessibility information about our campus. Equality Impact Assessments are carried out for new builds and feedback given to architects to ensure they are built with accessibility in mind, for example Changing Places accredited toilets, breast-feeding rooms and gender-neutral toilets. AccessAble conduct a full access audit of the University site, which is reviewed annually. From the audit, a list of priorities is created for the Estates & Facilities team to implement.

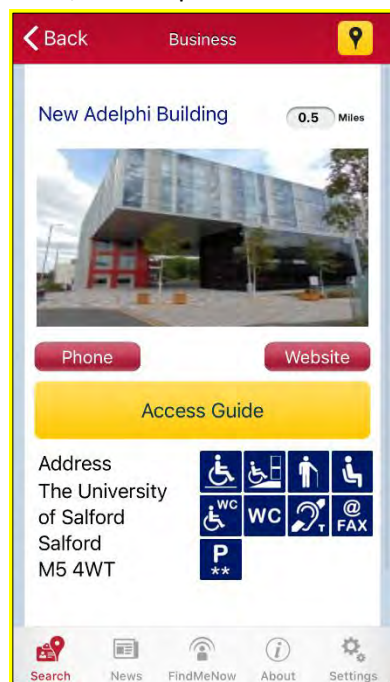

Figure 15: Screenshot from AccessAble app.

AccessAble also work with the University to provide a wayfinding tool which is [housed on our website](#) and can be downloaded as an app. In addition to the information on AccessAble website, site users can find their way around our whole campus and see detailed accessibility information about lecture halls, cafes and bars, toilets, and halls of residence with the free app, AccessAble Salford Uni. AccessAble helps the University to meet and deliver obligations under the UK Equality Act 2010.

### Security

The University Security Team patrol the University-managed areas and external CLV-managed areas, and there is 100% CCTV coverage of both campuses. Planned Preventative Maintenance is carried out by the Grounds Maintenance Team to ensure the safety of roads and pathways.

Access path to David Lewis Playing Fields has been improved – there is now a concrete path with barriers in place, which enables safe access from the Broadwalk to the Playing Fields.



*Figure 16: Concrete path to David Lewis Playing Fields and accessible path to Frederick Road Campus*

## Signage

A Signage Group has been set up at the University to manage signage maintenance and short, medium, and long-term plans for signage. Following the establishment of this group, some duplicated and confusing signage has been removed and new wayfinding signage implemented. All signage is designed following the University's branding guidelines. On events such as open days and graduation, additional signage is provided. The phone number for security is located on the entry sign at Cockcroft Road. Staff and students have details of how to contact Security on their ID cards.



Figure 171: Wayfinding signage.



Figure 22: Campus map signage

In 2024 the [heritage trail](#) was launched which comprises a route of 12 wooden signposts around campus with QR codes, linking to images of the changing shape of the University Campus, Salford Museum and Art Gallery.



Figure 18: Heritage Trail route

---

## Equal access for all

As a university, the main users of our site are students and staff, but due to our location, the wider community also use the campuses. The Broadwalk acts as a cut through between the A6 and north of the campus, and the Sports Centre is open to members of the public. Community groups can use the David Lewis Playing Fields and the pitches can be booked out. The Salford Connectivity Plan includes ideas to provide more links with Peel Park and “bring the park onto campus.” As mentioned above, site users can use the AccessAble app or website to look up accessible areas on campus. Estates-appointed contractors are provided with a Work Authorisation Certificate, which includes a photograph, and which they wear on their person. Staff have ID cards on lanyards and are encouraged to be helpful and courteous to students and other visitors.



*Figure 19: 3G pitch on David Lewis Playing Fields.*



*Figure 20: David Lewis Playing Fields.*

# Healthy, Safe and Secure

## Appropriate provision of quality facilities and equipment

### Fitness Facilities

A range of facilities are provided on campus to keep site users healthy. The [Sports Centre](#) contains a swimming pool, state of the art fitness suites, and offers a range of classes. There's also an outdoor gym situated outside of the building. The 3G pitch on David Lewis Playing Fields is suitable for football and rugby and sits beside two grass football pitches. There is a university running group and running events take place throughout the year, including the Vice-Chancellor's Fun Run and Santa Dash. A Parkrun also takes place on campus, with the route going through Peel Park and David Lewis Playing Fields. Walking and outdoor meetings are encouraged through our Green Impact programme, which is one way in which staff get involved in sustainability by creating teams, completing actions through a website and collecting points.



*Figure 21: Outdoor gym in front of the Sports Centre and David Lewis Playing Fields*

The Engels' Beard climbing sculpture, in the shape of the beard of German philosopher Friedrich Engels, is situated in Chapman Square close to New Adelphi building. It's an interesting and interactive 16ft sculpture that doubles as a climbing frame and acts as a 'symbol of wisdom and learning'. The artificial boulder features a climbing wall at the front, stairs to the rear and a viewing platform at the top, from which climbers can admire the view across Salford.



*Figure 22: Engels' Beard climbing sculpture.*

## Seating

Outdoor seating is provided across campuses, including in the memorial garden close to Cockcroft building, Community Growing Space behind the Clifford Whitworth Library, in Chapman Square, and in the Adelphi courtyard. Seats are also present in the outdoor classroom behind the Sports Centre and at the University House entrance.



Figure 23: Chapman Square outdoor sitting spaces.

## Catering

As of August 2024, catering is provided under University of Salford's Food and Drink Team's control. They work closely with the Environmental Sustainability Manager to improve sustainability across their supply chain, packaging, waste, and service. The Students' Union Atmosphere bar and café in University House also cater for site users.



Figure 24: Maxwell building canteen.

Toilets are located all over campus; these include disabled and gender-neutral toilets, and the majority are accessible to the public during building opening hours.

## Safe equipment and facilities

Planned Preventative Maintenance for internal staff, contractors and statutory inspections are captured in the Maintenance Planner, which is managed by the University Engineer. Inspection regimes, cleaning and maintenance schedules are managed via the internal facilities management

system. This includes inspections and cleaning of the Engels' Beard climbing sculpture every two weeks; roads, paths, drains and gullies are inspected monthly. The outdoor gym is checked daily during Duty Officer building checks, with cleaning carried out when needed and maintenance issues being raised on the internal facilities management system. All site users can report any problems to the maintenance department via the Helpdesk; issues will then be prioritised, and tickets will be raised to deal with them.

The Events Team within the Marketing and External Relations department work with the Estates Events Coordinator and the Health and Safety department to ensure events are managed safely onsite. Risk assessments and safety plans are developed for each event.

The Estates & Facilities Division has a Gritting and Snow Clearance Procedure which details the responsibilities of university staff in pre and post season preparation, but also of ICEWATCH Ltd who are contracted to undertake gritting when required, from the first week of November until the first week of April (variable based on need). ICEWATCH Ltd will undertake a daily check of the Met office 5-day weather forecast and advise the University when there is the strong likelihood of heavy snowfall or frost, with a 1 Degree Celsius default trigger. If agreed and authorised, ICEWATCH Ltd will attend, and grit all identified areas of the full campus and may be called to return to site if conditions are severe enough to warrant secondary treatment or snow clearance. The procedure also details University staff action if additional gritting or clearing is required, and the communication process for snow bulletins, for example in the case of the University having to close.

## Personal security

There is a 24/7 security presence on site and full risk assessments are carried out for all activities that the Security Team carry out, as well as assignment instructions. Full major incident and business continuity plans have been developed. All security staff are DBS enhanced checked as a minimum. Staff and students receive health and safety inductions and the Security Team provide alarms and bottle protectors to students. There is 100% CCTV coverage on site and all walkways and car parks are illuminated with LED lighting. The campuses are part of the patrol route of one Police Officer and two PCSOs. The [Equality, Diversity and Inclusion Statement and strategy](#) ensure that issues that cause fear for different members of the community are considered. Incidents and near misses are captured via an electronic portal. They are investigated appropriately and communicated via the Health and Safety Committee. All Security Guards offer first aid and can be contacted by calling 0161 295 3333; this number is provided on all staff and students' ID cards. There are also specific first aiders for hazards, as well as Mental Health First Aiders, in the Schools. Defibrillators are located across campus and at each site there is also an emergency first aid cabinet. Basic life support training sessions, such as CPR, are held regularly for staff and students. There is a weekly job ticket on the internal facilities management system to check fire exits, defibrillators, fire alarms, etc.

## Control of dogs/dog fouling

There are no issues with dog waste across the University, so we do not have any dog waste bins. This is reviewed regularly and if dog waste does become an issue, bins and signage will be installed. The Assistance and Other Animals on Campus Code of Practice details the University's expectations and

processes with respect to staff and students wanting to bring animals onto campus for a variety of reasons.

# Well Maintained and Clean

## Litter and waste management

Litter picking is carried out across campus every day by the Grounds Maintenance Team, as well as Building Attendants who litter pick the entrance of their buildings every morning and building perimeter as required. If any sharps are found, Security are contacted, and they attend promptly to dispose of them into appropriate containers. The University does not have an enforcement policy for litter, but this comes under the responsibilities of Salford City Council. There is also a fortnightly Hedgehog Friendly litter pick organised with the Peel Park Rangers that covers elements of the campus as well as the park.

The Grounds Maintenance Team are responsible for emptying all outdoor bins/recycling banks – this is carried out daily. When heavy footfall is expected or events occur, additional temporary general waste and recycling bins are placed in busy areas.

As part of our annual engagement programme, Go Green Salford, additional volunteer litter picks are usually carried out and the Students' Union also organise litter picking events on campus throughout the year. Road sweeping is carried out daily on all hard-standing areas. Hard to reach areas are blown out into the path of the road sweeper using leaf blowers where necessary. Waste collected from the road sweeper is litter picked, then is stored in a bay; when full, a skip is hired to dispose of this mixed waste.

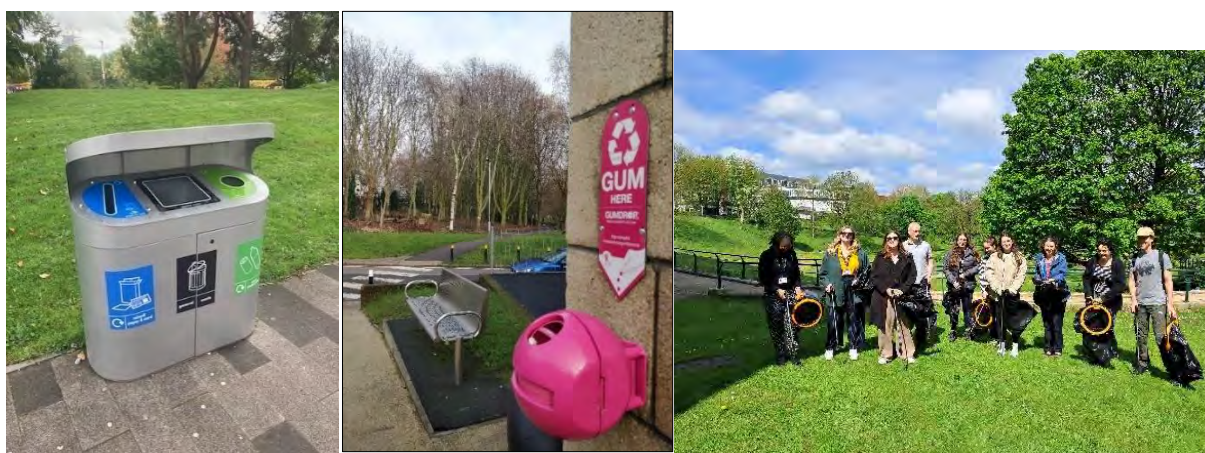

Figure 25: Recycling station, gum drop bins and picture of fortnightly litter pick

Most litter bins are part of recycling banks, so recyclables can be segregated from general waste. They contain three separate sections: general waste, paper, and mixed recycling (plastic bottles and cans/tins). An exception to this is on David Lewis Playing Fields where single general waste bins are provided as the majority of the waste generated here is from dog walking.

The University's recycling rate in 2023/24 was 47% and we have an objective to increase this to 50% by 2025. Correct recycling is promoted via signage, on our website, social media, and through events and pop-ups.

---

Cigarette bins are provided in allocated smoking areas and are monitored and emptied regularly. Bins for used chewing gum are also located across campus. These pink Gumdrops are monitored by the Grounds Maintenance Team who will replace the insert with a new one and organise collection by Gumdrops Ltd for recycling once enough full inserts have been collected. Gumdrops Ltd. recycle the waste gum into new products, including more Gumdrops, reusable coffee cups and guitar picks.

Site waste storage areas are positioned out of sight of the public and arrangements are in place to ensure that waste is transported off-site as quickly as possible. Padlocks have been installed on each waste storage compound across the campuses to make them more secure, and accessible only to relevant staff members. If fly tipping is found on site, it is logged with police and an incident number raised as outlined in the Environmental and Energy Management System Flytipping Procedure. Waste is inspected for addresses and then removed to places of approved disposal.

There is not a major problem with graffiti on campus, but if found it is removed using a hot waterpower steamer rather than with chemicals. During 2024 weekly campus inspections have been implemented which checks on a range of issues including graffiti and general housekeeping of the campus.

The Grounds Maintenance Team aim for zero removal of green waste from site – if green waste can be used on site, this is the more favourable option. Grass is cut on the mulching setting and left in situ. Wood waste is chipped by contractors on request and stored for use on beds and other areas as a weed suppressant.

Food waste from the catering kitchen areas is segregated for off-site anaerobic digestion by our waste contractor. Food waste from some smaller staff or student kitchen areas is also collected and this service can be requested by staff via their Building Manager.

## Maintenance planning

The Grounds Maintenance Team meet every week to discuss plans for the week and projects that are upcoming, and to allocate tasks. There is a documented Planned Preventative Maintenance regime for landscape maintenance; this, as well as reactive works, is detailed on the internal facilities management system, which can be viewed on request by Green Flag judges. The Team also work flexibly according to weather conditions and health and safety issues are always prioritised – for example, gritting pathways and roads before and during icy conditions, and checking trees after strong winds.

The Grounds Maintenance Team's work is based on a Service Level Agreement (SLA) between Estates & Facilities, and the Schools and Professional Services Departments of the University of Salford. The agreement covers the implementation of routine maintenance of the University's campus grounds, as well as providing both planned and reactive maintenance, to ensure that the campus grounds are maintained in a safe and tidy manner to the satisfaction, safety and enjoyment of students, staff, and visitors. Monthly schedules based on the SLA are used for planning the Grounds Maintenance Team's work and a monthly internal audit is carried out to ensure standards are met.

## Horticultural maintenance

All Grounds Maintenance Team staff have Level 2 NVQ Horticulture plus additional certification where needed. This is recorded in the Estates training matrix.

---

Street furniture and outdoor features are maintained regularly to ensure their safety. This is managed through the internal facilities management system.

When outsourcing maintenance, tenders are not only assessed on cost but also quality, for example assessing health and safety, staff experience and environmental impact.

The maintenance process of shrubs and trees takes into consideration the potential for nesting birds, particularly as they become larger and more mature. Hard pruning, branch removal or felling, if required, aims to avoid the bird nesting season where possible. If not possible, checks of the vegetation to be affected are made by an experienced ecologist no more than 48 hours before removal to ensure that no active nests will be damaged or destroyed in the process.

## **Arboriculture and Woodland Maintenance**

A mandatory five-year tree survey is conducted by an external professional tree inspector; the last one was completed in 2024. The inspector's report details locations of trees on plans, species, individual tree tag numbers, approximate age, height, condition, and recommendations. All works identified within the report are carried out within the timescales set in the report, including the removal of dead and damaged trees. Certified arboriculture contractors carry out the works. The Grounds Maintenance Team carry out minor pruning works. A visual tree inspection is carried out by the Grounds Maintenance Team following adverse weather.

## **Building and Infrastructure Maintenance**

The University of Salford campuses include buildings of various ages, scales, styles, and use. All buildings are maintained by the Facilities and Maintenance Team, which includes Building Managers, Handy Persons, University Engineer, Multi-Skilled Trades (Electrical, Mechanical and Joinery) and Building Attendants. Where necessary, outsourced contractors are used for maintenance. There is a documented Planned Preventative Maintenance regime for all aspects of building and infrastructure maintenance, which are detailed on the internal facilities management system.

Planned Preventative Maintenance for internal staff, contractors and statutory inspections are also captured in the Maintenance Planner, which is managed by the University Engineer. Inspection regimes, cleaning and maintenance schedules are managed via the internal facilities management system. This includes inspections and cleaning of the Engels' Beard climbing sculpture every two weeks, and monthly inspections of roads, paths, drains and gullies. The outdoor gym is checked daily during Duty Officer building checks, with cleaning carried out when needed and maintenance issues raised on the internal facilities management system. All site users can report any problems to the maintenance department via the Helpdesk; issues are then prioritised, and tickets raised to deal with them.

## **Equipment Maintenance**

All hand-held equipment is serviced at least once a year and all tractors and ride-on mowers are serviced twice a year, to ensure they meet PUWER legislation. This is managed through the internal facilities management system and is tracked by the Grounds Maintenance Team via a maintenance schedule. Vehicle maintenance is managed by the Transport Department. PAT testing is carried out by

our internal dedicated PAT testing officer. Basic maintenance such as cleaning and oiling is carried out by the Grounds Maintenance Team when required. All equipment is stored securely when not in use.

# Environmental Management

## Managing environmental impact

The University impacts on the environment in several ways and a systematic approach is taken to manage this. Environmental and Energy Management System (EEMS) is in place for the University's Estates and Facilities Division, in line with international UKAS standards ISO 14001 and ISO 50001.



Figure 26: EcoCampus Platinum, ISO 14001 and ISO 50001 logos.

The University used the EcoCampus scheme to implement the EEMS, which is a phased approach to environmental management systems, specific for Higher Education. We achieved Platinum EcoCampus, ISO 14001 and ISO 50001 certification in 2019, and have maintained it since.

The Environmental Sustainability Policy and Energy & Water Policy can be viewed [here](#). There are also policies and procedures relating to sustainable purchasing, construction, waste management, reuse, discharge to drains, spillage response, F-gas management and heating and cooling. We also undertake regular inspections of the campus and raise any issues found through our Non-Conformity Log.

As part of the EEMS, objectives and targets have been set for environmental and energy improvements. The University also has a specific Energy, Water and Carbon Management Plan which sets a target to reduce Scope 1 and 2 carbon emissions by 81% in absolute terms by 2030/31, based on 2005/6 baseline, with an interim target to reduce emissions by 71% in absolute terms by 2022/23 which has been achieved. The University is also working towards net zero carbon by 2038.

Examples of measures already taken to reduce impact on the environment include reusing rainwater and installing solar panels on the New Adelphi building, phased replacement with LED lighting, insulation improvements in buildings, improvements to Building Management System and controls, and food waste composting on site.

We also have an Environmental Communications and Engagement Strategy which includes initiatives to engage the University community with environmental issues and encourage pro-environmental behaviour change. For example, there is an online environmental induction for all staff. We also run the Green Impact programme, a sustainability accreditation scheme in which staff teams implement sustainable actions to build up points, achieving a Bronze, Silver, Gold or Platinum award. We also have an annual engagement programme, Go Green Salford, which takes place in February/March; it's a series of events and activities are organized over two weeks to promote environmental sustainability.

## Waste minimisation

Recycling is encouraged on campus, with recycling banks being present externally and internally for general waste, paper and card; and mixed recycling (cans and plastic bottles). Food waste caddies are in most staff/student kitchens and all canteen kitchens. Unwanted books can also be sent to Better World Books, either via the Environmental Sustainability Team or by requesting a collection box.

Staff are encouraged to minimise waste and unnecessary purchasing by using WARP-it, the University's internal reuse network. Staff can upload items they no longer need to the online system and claim and request items that they do need. If items are not reused internally, they can be reused within the locally community via WARP-it, for example by schools or charities.

## Chemical Use

The Grounds Maintenance Team aim to minimise pesticide use; in general, it is only used to control weeds on hard standing areas around buildings and courtyards. As part of an integrated pest management approach, the Grounds Maintenance Team hand weed where possible, however currently it is not practicable to hand weed all areas due to the size of the campuses. Pesticides and herbicides use is limited to promote and preserve wildflower areas and invertebrate communities they may attract. They are used on an ad-hoc basis to control the spread of invasive species. Invasive species mapping has been carried out by an invasive species management specialist, who advised the use of Glyphosate for the treatment of Japanese Knotweed, Giant Hogweed, Himalayan Balsam, and other invasive species. The University has a treatment regime that is audited by Urban Green and AECOM.

Roundup Provantage is used, and all staff that handle and apply it have PA1 and PA6 certification; it is stored in secure chemical lockers. All waste containers are removed by certified hazardous waste contractors. Any pesticides that are applied are recorded on a pesticide application record/invasive species treatment log, which details application dates of pesticides, operators, area treated (with map reference), application rates and weather conditions. Separate records are kept for the treatment of Japanese Knotweed.

Where fertiliser is needed to support tree and shrub growth, the applications are targeted so not to increase the nutrients within the soil of the wildflower area which may result in a loss of diversity within the plant sward. ClearRun Pro fertiliser is used on ornamental and front-facing lawns only. Staff are trained as above.

For the removal of chewing gum, EcoGum Remover Solution is used, which is a non-hazardous, environmentally responsible gum detergent.

## Peat Use

When compost is needed, only peat-free compost is used.

## Climate change adaptation strategies and water management

When new planting is being planned, the future impacts of climate change are considered. Species that tolerate higher temperatures and drier conditions are considered in the first instance. The Grounds Maintenance Team are moving away from annual bedding plants to perennial drought resistant ones that give flower for most of the year.

The University has a rainwater harvesting system on the New Adelphi building, which is used for flushing toilets in the building. The Grounds Maintenance Team have mulching at David Lewis Playing Fields and mulching is used for new planting, helping to conserve soil moisture. Watering plants is done in early morning and late afternoons to avoid excess evaporation, and it is the ground that is watered, rather than the plants. Watering is stopped if there is a hosepipe ban or if there are signs that one may occur.

In 2016, a land swap was carried out between the University and Salford City Council: the University gained David Lewis Playing Fields in exchange for Castle Irwell sports campus. Castle Irwell has been used as part of a £10m flood scheme which can protect almost 2,000 homes and businesses, hold more than 250 Olympic-sized swimming pools of water during a flood, and create more than 5 hectares of urban wetland habitat. The scheme was completed in February 2018 and delivers on the councils long-held vision to not only reduce the risk of flooding from the River Irwell, but also to provide a boost to local wildlife populations through creation of a high-quality urban wetland habitat.

The University has built a Nature-based Solutions Living Laboratory on Peel Park campus. This experimental research installation seeks innovation in urban green infrastructure and Sustainable Urban Drainage Systems (SUDS). Salford's Living Lab is part of the wider €6 million Urban Innovative Actions [IGNITION project](#), which aims to increase investment in green infrastructure across Greater Manchester and provide new and innovate financial mechanisms to green cities elsewhere.

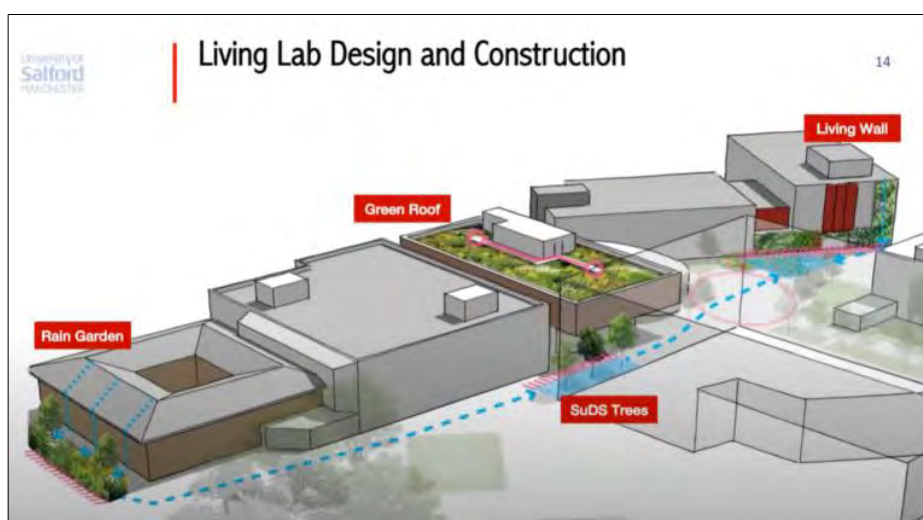

Figure 27: IGNITION Living Lab at the University of Salford Peel Park campus.

---

The Living Lab provides a visual and technical demonstration of the measures needed to adapt to the climate change emergency and extreme weather. The installation comprises a rain garden, living wall, Sustainable Drainage-enabled street trees, and a green roof. There is a high degree of interpretation through live data monitoring, as well as interaction with students, staff, the curriculum, investors, the wider community, and other stakeholders.

As part of the engagement and interaction programme for the Living Lab, the team has organized a series of events, workshops, and university activities to harvest the potential of the Living Lab and ensure that as many people as possible benefit from it. In coordination with IGNITION partners, the University's research team has been organizing specialised events for stakeholder groups including community members, green infrastructure investors and academics in the relevant fields. They have also conducted educational tours for Salford students and organised research collaborations with educators at the University as part of innovation in the curriculum. The tours extended to Schools as part of our partner organised School Challenge (RHS-organised). We have also presented the work done at the Living Lab via engagement programmes during national events, such as COP26 and our researchers have recently attended COP28 in Autumn 2023.

---

# Biodiversity, Landscape and Heritage

## Management of natural features, wild fauna and flora

Despite being just a mile and a half from the City of Manchester, the main site of the University of Salford is a leafy, riverside campus adjacent to Peel Park and the River Irwell.

A survey of habitat types was conducted in 2014 to produce a baseline of habitat areas using the Biodiversity Index, an online survey and calculation tool developed by University of Northampton. The Biodiversity Index score for the site was 186. 37 parcels of land and six broad habitat types were identified across the site. Short grass was the most numerous habitats identified, with 11 plots. Other broad habitats were Rows of Trees, Varied Habitat, Planted Flower Border, Hedges & Shrubbery, and Groups of Trees. We have plans as part of our Public Realm Project to repeat the Baseline Ecological Assessment during 2025.

### Trees on Campus

There are a large variety of trees on campus including sycamore, birch, willow, whitebeam, cherry, Norway maple, oak, hawthorn, and London plane. Our priority is on protecting mature trees wherever possible. For new planting, native species are prioritised and where removal cannot be avoided, the University has a two-for-one tree policy, which requires the planting of two trees for every one removed.

In the woodland areas around David Lewis Playing Fields, the most significant trees are Salix, Acer and Populus species. When tree work is carried out, habitat piles are left in secure woodland locations on campus to promote biodiversity and achieve the target of zero green waste removal. In March 2020, nearly 600 tree whips were planted on David Lewis Playing Fields during a community event with City of Trees, as part of our Go Green Salford events. In January 2022, together with City of Trees, staff and students from the School of Arts, Media and Creative Technology, planted another 210 trees on the Playing Fields. In April 2024 City of Trees planted 30 more trees to further expand the woodland, including Ginkgo, Bird Cherry, American Sweetgum among other unique species. We have also supported SCC with several tree planting events at Crescent Meadows.

To the west of David Lewis fields is a small woodland, known as Strawberry Hill Woodland, containing Willow, Maple and other species and an outdoor classroom space. This space is managed in conjunction with Salford City Council who own most of the land. In 2024, a draft Woodland Management Plan has been developed which proposes a partnership approach to improving its condition including planting a range of forest flowers.



*Figure 28: Strawberry Hill Woodland with outdoor classroom*



*Figure 29: David Lewis Nature Area*



*Figure 30: Memorial Trees Outside University House known as The Pinetum*

### Wildflower Planting

Wildflower seeds are used instead of bedding plants in some areas, and the campus features several wildflower patches, which are cut in later summer, allowing the flowering plants to set seed before they are cut. Arisings should be removed from the area to prevent nutrient enrichment of the soil and loss of sward diversity.

To the back of the Faith Centre and running alongside University Road is a grassy bank, which was previously the Manchester Ship canal that has now been filled in. Significant wildflower planting matured during 2024 presenting a colourful and diverse strip along the former canal.

Further wildflower planting is present along the entrance to and along the embankment near the Mary Seacole Building.



*Figure 31: Wildflower Embankment along University Road*



*Figure 32: Wildflowers on Frederick Road Campus*

During December 2024 approximately 58,000 spring flowering bulbs were planted in three key areas across campus: front of house along the A6, on the slope from the museum down to Peel campus and in front of university house (purple flowering to align with polio awareness campaign).



*Figure 33: Spring Bulb Planting in Autumn 2024*

### Wildlife on Campus

Our most recent biodiversity survey took part in March 2024, in the form of a two-day BioBlitz event for students, staff and our local community. The event was organised by the Environmental Sustainability Team, Salford Ranger Team, and the student Wildlife Society. Over 70 species were recorded, and the results were submitted to the Greater Manchester Ecology Unit.

Wildlife that has been seen on campus includes grey heron, kingfisher, long-tailed tit, blackbird, song thrush, mistle thrush, pied wagtail, wren, and hedgehog. Bird boxes are located on some trees across the Peel Park campus, including in the Clifford Whitworth Library courtyard, which also contains two small bug hotels. The IGNITION Living Lab also features several bug hotels and bird houses on the Living Wall. Another research facility on Peel Park campus, the Z House, also features houses for swifts, bats, and hedgehogs, as well as an insect hotel. The boxes are monitored for wear and damage and replaced as needed. We continue to aim to increase the provision of bird boxes, bug hotels and other wildlife habitats on campus.

The newly completed development located next to the main campus, the North of England Robotics Innovation Centre (NERIC), features a brown roof, which is to be managed and maintained according to the guidance supplied by the specialist provider of the roofing substrate and sedum plants. On the

Peel Park Campus the New Adelphi Building has a brown sedum roof and there is a green roof on Lady Hale Building.



*Figure 34: NERIC brown sedum roof*



*Figure 35: Bird box and bug hotels in Library courtyard.*



*Figure 36: Bird houses and bug hotels on the IGNITION Living Wall.*

The Grounds Maintenance Team ensure they limit disruption to nesting birds; tree work is avoided where possible during bird breeding season, but if it is required during this time, nests are checked prior to any works being carried out and if they are in use, work is stopped until after bird breeding season.

We are aware of several colonies of bees on campus, including mason bees and mining bees. In January 2025, seven bee posts were installed in various locations for solitary bees to supplement existing nesting habitats on campus. Our intention is also to provide further nesting habitats by drilling holes into dead wood within our woodland areas.



Figure 37: Bee posts installed in January 2025.

### Hedgehog Friendly Campus

The University signed up to the [Hedgehog Friendly Campus](#) programme in 2020 and in July 2024, we achieved the Platinum accreditation level. As part of the programme, staff, students, and members of our local community are working together to raise awareness of issues affecting hedgehogs and make our campus a safe and welcoming place for them. As part of the programme, staff and students can become Hedgehog Champions and Ambassadors. It has been a very popular initiative and a fantastic way to engage with the Green Campus Group. We have installed hedgehog signs, highways, and houses on campus for example in Strawberry Hill and David Lewis Playing Fields.

According to the [British Hedgehog Preservation Society](#), creating a safe and welcoming environment for hedgehogs includes:

- Installing hedgehog highways (13x13cm/5x5" holes in walls or fences) to allow hedgehogs to roam freely, and to provide escape routes.
- Installing ramps on ponds and pools to provide escape routes.
- Creating wild corners to provide nesting spots and food (insects).
- Litter-picking regularly.
- Providing water and food (hedgehog or meaty cat/dog food).
- Avoiding using chemicals.
- Checking before using machinery and lighting bonfires.
- Making/providing hedgehog houses.

Apart from completing most of these on our campus, since joining the programme we have also run awareness campaigns and fundraising events for the British Hedgehog Preservation Society and conducted several hedgehog surveys and workshops.



*Figure 38: Hedgehog houses and highway around Peel Park campus.*

## Conservation of landscape features

Although the University is a relatively recent development and so lacks historic features, it does sit next to Peel Park which was opened in 1845-46 and is owned and managed by Salford City Council. It is one of the oldest purpose-built public parks in the country and was funded by public subscription.

There are no tree preservation orders on site, but part of the Peel Park campus is located within The Crescent Conservation Area (Figure 38), where planning permission is required for any tree work. The area spans from David Lewis Playing Fields across Peel Park, linking in Peel and Maxwell and across the A6 along the Crescent from Christchurch Orchard to Oldfield road.

The map presented on Figure 39 shows the area where the David Lewis Playing Fields are now situated in 1850, whilst Figure 40 shows the area in 1909, as the David Lewis Recreation Ground.

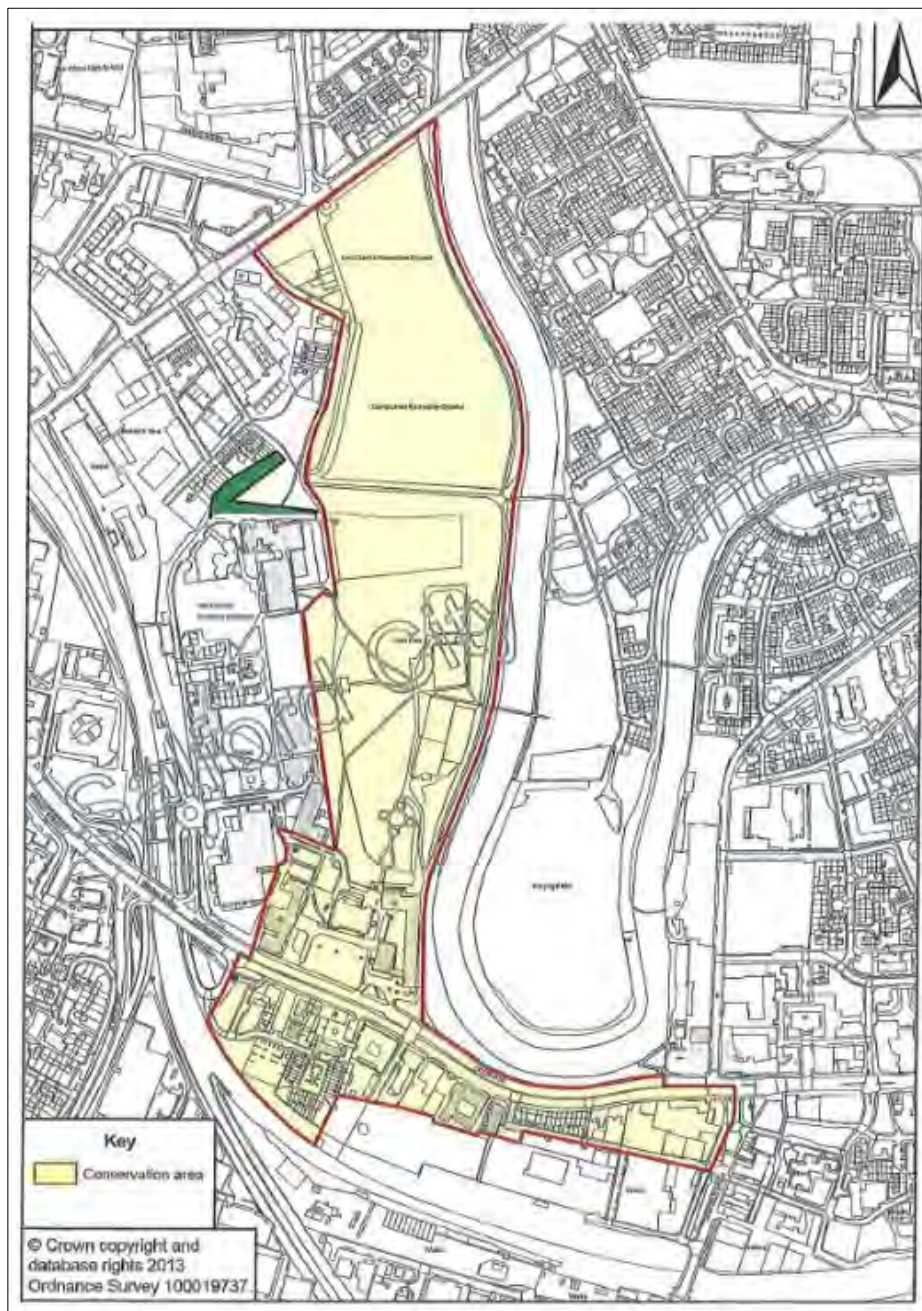

Figure 39: Map showing The Crescent Conservation area.



Figure 40: Map from 1850 showing the area where the David Lewis Playing Fields are situated.

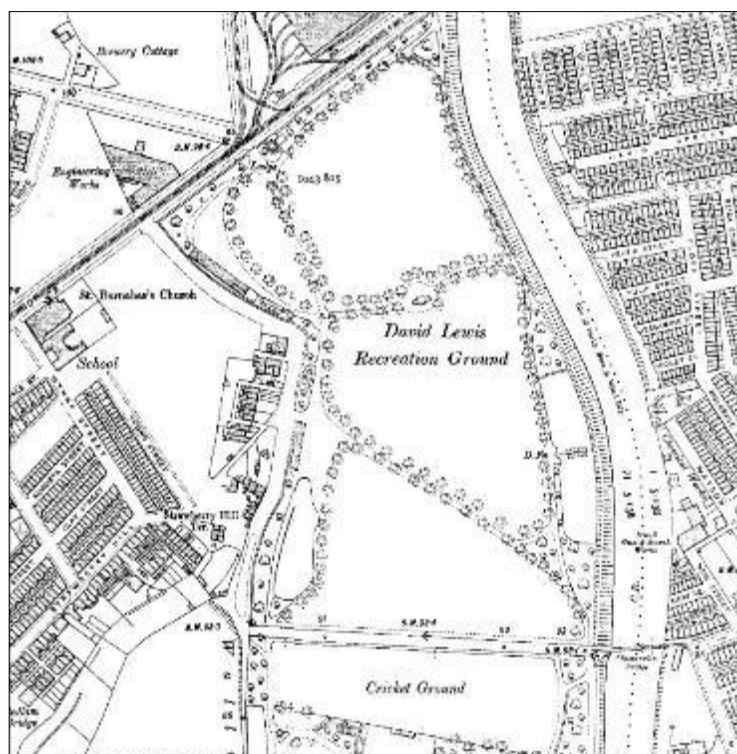

Figure 41: Map from 1909 showing the David Lewis Playing Fields, also known as the David Lewis Recreation Ground.

---

## Conservation of buildings and structures

As mentioned earlier, part of the University sits within the Crescent Conservation Area, which was reappraised in 2008. If any work is to be carried out on any buildings within the Conservation Area, the Projects Team apply for conservation area consent.

All Grade II listed buildings are maintained and managed carefully and sensitively for preservation. If the University requires any work that affects the original fabric of any Grade listed buildings, the Projects Team apply for listed building consent. Other Grade II listed buildings and structures in the area that are not owned by the University include Salford Museum and Art Gallery, the statues of Queen Victoria and Prince Albert, and the phone box at fire station square.

University buildings of significance include Peel Building, which is Grade II listed and houses Peel Hall as well as teaching space for part of the School of Science, Engineering and Environment. This grand Victorian building was designed by architect Henry Lord and built in 1886. It was originally the Salford Royal Technical Institute, and the façade is constructed of red Accrington bricks and sculpted terracotta.

Joule House is also Grade II listed and was once home to the scientist James Prescott Joule, who conducted experiments into the nature of heat when he lived there, and whose name has been given to the unit of energy, the Joule. In keeping with this area of work, the building now houses the University's Smart Meters Smart Home (SMSH) Lab facility.

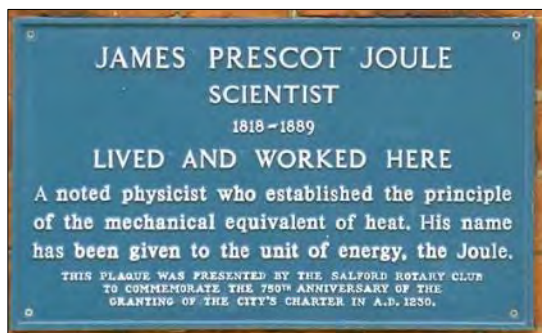

*Figure 42: Plaque on Joule House.*

The nearby Old Fire Station is a locally listed heritage asset and has recently been converted to a café/bar.

### Outdoor Sculptures

The three totem sculptures in the front courtyard of the Allerton building are Grade II listed. The sculptures were created in 1966, by William Mitchell for the forecourt of the Allerton Building which was opened in 1966 and originally formed part of Salford Technical College. The building was designed by Manchester-based architects' practice Halliday Meecham who commissioned the London sculptor William Mitchell to produce a piece of landscape art to add interest in the forecourt of the building.



Figure 43: Totem sculptures.

Mitchell designed a composition of three concrete figures with features suggestive of Mayan or Aztec culture. Each figure was constructed from four concrete blocks and was made on site using polyurethane moulds. The faces of the columns are differently detailed, some with organic forms recognisable as human features such as faces, eyes, and arms. Great care was taken in their positioning, both to illuminate and animate their stylised faces through the direct fall of morning and evening light, and to encourage the proximity of, and thus interaction with, students passing close by to exit the complex into the wider neighbourhood.

There are various sculptures in campus including that in front of the Mary Seacole building known as the 'Clasp' sculpture. It represents the space between two hands gently clasped, a homage to our School of Health and Society.



Figure 44: 'Clasp' sculpture outside Mary Seacole building

During Autumn 2023 a new sculpture was installed at Chapman Square as part of Mind Manchester's 'Six Places in a Different Light' exhibition, known as 'Embrace' to promote mental health awareness and wellbeing across Greater Manchester.



*Figure 45: Salford mind sculpture*

---

# Community Involvement

## Community involvement in management and development

A Green Campus Group (GCG) has been established, which is open to staff, students, and the local community. The purpose of the group is to share information and engage with the University community about the current and future/potential use of outside spaces at the University of Salford and how they will and could be developed and enhanced. The Terms of Reference can be viewed [here](#).

The aims of the Green Campus Group are:

- To gain an understanding of how outside spaces on campus are used by staff, students, visitors, and the local community, including how they are used for learning/educational purposes, to feed into the Landscape Management Plan.
- To actively involve users in identifying opportunities for improvements and to collaborate to implement them where possible.
- To share information with Green Campus Group members about how developments of the campus will impact on outside spaces.
- To gain ideas and information for the University's Landscape Management Plan and associated action plan, which are led by the Estates & Facilities Division.
- To support the Green Flag Award application.

An online sharing platform on Microsoft Teams is used to regularly update members and to share ideas and information. Currently, members of the GCG are predominantly staff and members of our local community, so the aim is to encourage more students to join. To achieve this, we are working closely with the Students' Union and the student societies. As mentioned earlier, the Campus Connectivity Plan (previously known as The Masterplan) will involve improving the public domain and establishing strong physical links between the University and local communities. Staff, students and members of the public were consulted regarding the Connectivity Plan, and were invited to attend drop-in events or to share their views online on the [Masterplan vision](#). The Associate Director of Development, who is involved with the Connectivity Plan, is a core member of the GCG to ensure that Masterplan developments are shared with the Group and that ideas that the Group want to take forward are not affected by the Connectivity Plan. At meetings so far, members have shared their ideas for improvements, picked their favourites and we have been working to take the top improvements forward, including:

1. River Irwell clean-up – There have been three river clean-up events in 2019 and 2021; we are planning to organize more of these in the future.
2. Habitat/species surveys – We have organized several hedgehog surveys as part of the Hedgehog Friendly Campus programme. We also run a two-day BioBlitz event every March and September in collaboration with Salford Ranger Team and the Wildlife Society.
3. Community Growing Space – We held a focus group about the project and used the ideas raised to identify a suitable location and develop a design for the space, that is accessible and reuses materials. With funding from the Salford Advantage Fund, the space has been launched in 2022 and now students, staff and local community members use it to rest, socialise, study, or work.

---

## Appropriate provision for the community

As detailed in the *Marketing and Communication* section below, ‘the community’ includes staff, students, the local community and residents, the Students’ Union, student societies such as the Wildlife Society, and the Friends of Peel Park group.

Our campus green space has important contributions to make to our natural environment not only in terms of addressing pollution, increasing biodiversity, and mitigating and adapting to climate change, but also supporting physical and mental health of our staff, students and local community. A range of recreational facilities and activities are available for the community, as detailed below, and this will be improved by learning from and working with the GCG. If facilities or activities are suggested that cannot be provided, feedback will be given at GCG meetings.

### Sports facilities

As described earlier, the University’s [Sports Centre](#) is open to staff, students and the local community and is open seven days a week. Facilities include five fitness suites and a fitness studio used for a range of classes including yoga, Salfit and Zumba. There is a large multi-use sports hall containing six badminton courts, two basketball courts, a five-a-side football pitch, netball court, handball court and Futsal pitch. There are also two squash courts and a 25 metre, 5 lane swimming pool complete with sauna and spa. Sessions at the pool include general swim sessions, SwimFit and swimming lessons. Students’ Union activity groups also use the pool for canoeing, scuba diving and swimming.



*Figure 46: Swimming pool.*

Students’ Union sports clubs use the facilities and there is also the option for students to participate within a semi-competitive (and more recreational) activity setting via the Students’ Union’s Give Sport a Go Programme.

The David Lewis Playing Fields host a 3G pitch that can be used for rugby and football, alongside two grass football pitches. There is also an outdoor gym to the front of the Sports Centre, as well as the Engel’s Beard climbing sculpture outside the New Adelphi building.

There is also a university running group and running events take place throughout the year, including the Vice-Chancellor’s 5K Run which is adapted each year and includes the campus, David Lewis Playing Fields, and Peel Park.

---

## Arts and Performance

The £55m New Adelphi building was opened in September 2016, delivering a new home for music, performance, art, design, and architecture students, and providing a rich environment for creativity, arts, and culture on campus.

Bringing together both development and performance in one highly technical facility, New Adelphi provides inspiring spaces for learning and collaboration, while also offering a venue for a varied cultural programme, for students, staff, and the public to enjoy. This includes the 350-seater New Adelphi theatre and the Amphitheatre, a performance space that can be linked to the theatre and offers a unique environment for outdoor events. Events held at New Adelphi include conferences, drama productions and art exhibitions.

Peel building is also host to conferences and events, particularly in Peel Hall which seats up to 300 people. The hall has been used for musical performances and recordings, including by the BBC Philharmonic orchestra. In 2024 Peel Hall, Maxwell Hall and The Old Fire Station hosted part of the [‘Sounds from the Other City’](#) music event which saw thousands of people flock to our Peel campus.

## Events

The University hosts many events throughout the year, some aimed at staff or students, and many open to all. These include events run by the Students’ Union and Welcome Week events for new students. Open Days and Applicant Visit Days are held for those interested in learning more about the facilities and life at the University of Salford. Visitors have the chance to hear from academic staff and current students across the range of courses on offer at Salford as well as viewing the campus and facilities. Every Wednesday, there is a pop-up market in Chapman Square for small businesses selling food, handmade jewellery, second-hand clothing and plants.

## Dementia Hub and Garden

The Dementia Hub, part of the [Salford Institute for Dementia](#), displays dementia-friendly design and was designed and built-in consultation with the Institute’s dementia associates, demonstrating their engagement with the local community about the work they do.



Figure 47: Dementia Hub Garden.

The Good-life club meets fortnightly at the Dementia Hub and is a living-well group for people affected by dementia. Since the Hub was launched, the focus has been on gardening, maintaining the new outdoor space at the hub and finding spaces to grow edibles. With the help of the gardening team at the University and support from Incredible Education the group have planted seeds for herbs, beetroot, spinach, potatoes and bought young tomatoes, strawberry and other edible plants that have been planted up in baskets and tubs.

There are always some jobs to do; those who are not interested in gardening can use the Hub space to chat, read, engage in craft activity, or relax in the pergola in the centre of the garden which has evolved into being a special space for reflection. As the group develops and new members join, the impact of this work and people's experience is to be evaluated by researchers at the Institute to learn more about the benefit of these activities on living with dementia.

### Community Growing Space

In June 2022, the Community Growing Space was launched behind the Clifford Whitworth Library. The idea was originally proposed during a Green Campus Group meeting and taken forward by the Environmental Sustainability Team. Funding of £4,000 was received from the Salford Advantage Fund; this was used to prepare the space by creating a hardstanding and purchasing planters and tools. The garden now features 8 planters, a tool shed, four benches, two greenhouses, a bug hotel, and a bird feeder. All wooden features were made locally, from reclaimed wood.



*Figure 48: Community Growing Space.*

Two patches of wildflowers have also been created which attract many pollinators in the warmer months. Most of the flowers, herbs and vegetables have been planted using bulbs and seeds donated by our community; students, staff and visitors were also encouraged to help themselves to the resulting produce, so that the garden can “give back” to them. Several events have taken place in the community garden, involving the Sustainability Team, the student Wildlife Society, Salford Ranger Team, and local community members and groups, such as Growing Togetherness based in Buile Hill Park. Throughout spring and summer 2023 we also ran weekly community gardening sessions. We are working on establishing a regular volunteering group to ensure the garden is being properly maintained and developed.



*Figure 49: Planting event at the Community Growing Space led by the student Wildlife Society.*

### Go Green Salford

Every March and October, the Sustainability Office organise a programme of free events and activities to raise awareness of sustainability issues and provide opportunities for staff, students and the local community to get involved and take action. The activities have included cycle maintenance workshops, litter picking, recycling roadshows, making mini-beast homes, vegetarian pop-us, nature walks, film screenings, tree planting, tree identification walks, and making Fairtrade smoothies using a cycle-powered machine.

### Library community access

Free library membership is available for members of the public, aged 16 and above, who live, work or study in the Salford area (post codes M3, M5, M6, M7, M50 and M60). Community members can borrow library items and use the free Wi-Fi.

### Educational activities

Various modules and courses use the campus as a learning and teaching resource. This includes the School of Arts, Media and Creative Technology using outside spaces for performances and filming, Built Environment students practicing surveying, and Environmental Management students conducting consultancy projects, such as Maximising Biophilic Effects and Streamlining Cycling Provision. An outdoor classroom is available for use and the Students' Union Wildlife Society use the campus for activities such as creating habitats for hedgehogs in the woodland area.



*Figure 50: Hedgehog nesting site.*

---

## Room Hire

Conferencing@Salford delivers venue and room hire, location filming and event-managed conferences. The level of input from the Conferencing Team can vary and catering is available. Because they are a social business, 100% of profits go directly to scholarship funds, providing a social impact. The Team have achieved the Silver Green Tourism award, as recognition for their commitment to people, places, and our planet. In 2024 they also achieved EcoSmart Gold Award, showing their dedication to providing sustainable events and are taking steps towards Platinum award.

## Faith Centre

The Faith Centre on University Road comprises of various facilities to meet the faith requirements of all users. It includes Chaplains Offices, a Chapel, Quiet Room, Social Space and Kitchens, Multi-Faith room, Muslim Prayer Hall and Ablution facilities and meeting rooms. The purpose of the Faith Centre is to support the spiritual wellbeing of students and staff, and to increase our understanding of, and respect for, religious beliefs and practices. It does so by providing opportunities for members of the University community to reflect, worship, contemplate, teach, and learn, read, and study, celebrate, mourn, engage in dialogue, and interact daily.



Figure 51: Faith Centre.

## Salford Tree Trail

A tree trail was first developed for the University campus in 2011 by student Oliver Bishop for his [dissertation](#). The original trail has been updated and developed into the Salford Tree Trail. It incorporates 25 trees and takes users around the main campus, Peel Park, David Lewis Playing Fields, and Crescent Meadows. Current version of the Trail is a result of collaboration between various teams from within and around the university, including the Environmental Sustainability Team, Salford Ranger Team, Maker Space, and students from the School of Arts, Media, and Creative Technology. All information about the Tree Trail is available to users on the dedicated [webpage](#), including a map of the three available routes. Each tree along the trail has its own plaque with a QR code, which can be scanned to access information about the species.

## Local schools and colleges

The University of Salford is committed to breaking down traditional barriers to Higher Education and ensuring that the student cohort reflects the diversity in society. The outreach team offer a variety of on and off campus activities for school and college groups, and work with teachers, careers advisors and parents to ensure that students are receiving the right information about university study. The teamwork with future applicants of all ages to raise aspirations and deliver information, advice, and

---

guidance about progression within education, and target groups who come from backgrounds under-represented in HE. Visits to the campus for schools and colleges can be arranged, to provide an insight into university life, and can include campus tours with current students, talks from current students about their experiences at university and subject specific taster sessions.

---

# Marketing and Communication

The list below details the current and potential information channels that can be used for marketing and promotion regarding site users, many of which have also been used to communicate our success in achieving the Green Flag Award. A log of interested parties has also been produced to enable consideration and analysis of the needs and expectations of site users and to evaluate the best marketing and promotional methods. A separate Environmental Communications and Engagement Strategy also exists (available on the [Sustainable Strategy](#) page), as part of the Estates & Facilities Environmental and Energy Management System.

Channels used for communications related to the Green Flag Award, biodiversity, and landscape management are listed below. Recent examples of such communications can be found in Appendix 2.

- Websites
  - Main University [website](#)
  - Estates and Facilities [website](#)
  - Environmental Sustainability [website](#)
  - Environmental Sustainability [blog](#)
  - Student [Hub](#) (internal page)
  - Staff [Hub](#) (internal page)
  - Students' Union channels (their website, social media channels and screens)
- Instagram:
  - Main University [account](#) (47.4k followers)
  - Sustainability Team [account](#) (1,089 followers)
- LinkedIn
  - Sustainability at Salford [account](#) (1,253 followers)
- Facebook
  - Environmental Sustainability Team [page](#) (674 followers)
- X:
  - Main University [account](#) (57.9k followers)
  - Sustainability Team [account](#) (2.5k followers)
  - [Account](#) for students (10.3k followers)
  - Library [account](#) (4.4k followers)
  - There are many other University Twitter accounts that may include relevant information via retweets and their own posts.
- Digital screens and screen savers
- Events
- Presentations
- Notices/signage/posters
- Monthly sustainability newsletters
- Green Impact staff engagement programme
- Green Campus Group Teams channel

## Landscape Management Log of Interested Parties

Site user	Needs and expectations regarding marketing and communication	Communication channels
<b>Staff</b>	Information about how they can use outside spaces for work and leisure. Opportunities to learn more about the environment and biodiversity on site and improve wellbeing. Information about how they can engage with outdoor spaces on campus and be involved in management and development of the site.	Website, social media, blog, staff channel, notices/signage/posters, digital screens/screen savers, events, presentations, newsletters, Green Impact, Green Campus Group.
<b>Students</b>	Information about how they can use outside spaces for study/research, leisure and wellbeing. Opportunities to learn more about the environment and biodiversity on site. Information about how they can engage with outdoor spaces on campus and be involved in management and development of the site.	Website, social media, blog, student channel, Student's Union channels, notices/signage/posters, digital screens/screen savers, events, presentations, Green Campus Group.
<b>Local community</b>	Awareness of the facilities available for the local community.	Website, social media, blog, events, notices/signage/posters, Green Campus Group.
<b>Friends of Peel Park</b>	Likely to have particular interest in David Lewis Playing Fields.	Website, social media, blog, Green Campus Group, Friends of Peel Park meetings.
<b>Salford Ranger Team / Peel Park Ranger (Salford City Council)</b>	Collaboration with events and activities. Promotion of the Park.	Green Campus Group, separate meetings.
<b>Wildlife Society and other student societies</b>	Information about how they can help to enhance biodiversity on site.	Website, social media, blog, student channel, Student's Union channels, notices/signage/posters, digital screens/screen savers, events, presentations, Green Campus Group.
<b>Students' Union</b>	Collaboration with events and activities. Information about how they can engage with outdoor spaces on campus and be involved in management and development of the site.	Website, social media, blog, staff channel, notices/signage/posters, digital screens/screen savers, events, presentations, newsletters, Green Impact, Green Campus Group.

# Management

This Landscape Management Plan was developed by the Environmental Management Coordinator in collaboration with the Landscape Team Leader, with contributions from other staff and departments across the University.

The Grounds Maintenance Team (GMT) is responsible for the general management of the outside spaces, but other departments are responsible for managing other areas relevant to the LMP e.g. the Environmental Sustainability Team (EST) in Estates and Facilities lead the management of the University's environmental impacts.

An action plan has been developed (see below). Actions have different funding sources and budget management depending what departments are responsible for their development. List of closed out actions can be found in Appendix 1.

The LMP is reviewed annually, including updating progress on the action plan and providing photo evidence where appropriate. A new plan will be developed from 2025/26 which will be closely linked to our new Public Realm strategy, currently under development.

## Action Plan

### Green Flag Award Criterium

Green Flag Award criterium	Action	20/21	21/22	22/23	23/24	24/25	Owner	Budget	Status (monitoring and evaluation)
<i>A Welcoming Place</i>	Review of Signage Across Campus						Campus Services	Campus Services	Quotation obtained from suppliers to improve external signage.
<i>A Welcoming Place</i>	Development of Equality, Diversity and Inclusion Design Standards.						Capital Projects Team	Capital Project	Consultant appointed. To be followed by audits of public realm areas.

<b>Well Maintained and Clean</b>	Regular Litter Picks of bushes in DLPP						Environmental Sustainability Team / Grounds Management Team	N/A	Includes bushes around DLPP during bi-weekly litter picks with Friends of Peel Park.
<b>Well Maintained and Clean</b>	Weekly campus checks on housekeeping, fly tipping and graffiti						Environmental Sustainability Team	N/A	Checks have been ongoing since March 2024
<b>Well Maintained and Clean</b>	Improve tree selection and woodland management						Sustainability Office / Grounds Management Team.	TBC	Tree Position Paper and Woodland Management Plan developed. Memorandum of understanding being developed with Salford City Council
<b>Environmental Management</b>	Review use of pesticides						Grounds Management Team (GMT)	N/A	Continuous review underway into alternatives to Glyphosate which is due to be banned (currently on label until 2025).
<b>Biodiversity, Landscape and Heritage</b>	Install further bird boxes and feeders.						Environmental Sustainability Team (EST)	Capital Budgets (swift boxes) Budget approved (bird feeders)	24/25 - Explore further 'swift bricks' on new buildings. 15 bird feeders on order Joiners to make additional boxes.
<b>Biodiversity, Landscape and Heritage</b>	Install further bee habitats (to compliment insect houses on Ignition)						EST/GMT	Budget approved	24/25 - 7 x bee posts installed and sand planter to follow for Community Garden. Signage on bee posts to explain how bees nest.

<b><i>Biodiversity, Landscape and Heritage</i></b>	Improve signage and Identity of green spaces						Environmental Sustainability Team (EST)	N/A	23/24 - Green spaces trail developed that identifies the key green spaces. 24/25 - Graphic design student project underway on signage.
<b><i>Biodiversity, Landscape and Heritage</i></b>	Plant more wildflowers on campus.						Grounds Management Team (GMT)	Capital Budgets	23/24 - Wildflowers present along University Road, Mary Seacole embankment and David Lewis. 24/25 - Enhanced grassland around capital projects to meet BNG commitments.
<b><i>Biodiversity, Landscape and Heritage</i></b>	Spring bulb planting						Grounds Management Team (GMT)	Public Realm	24/25 – 58,000 bulbs installed December 2024
<b><i>Biodiversity, Landscape and Heritage</i></b>	Ensure that Masterplan projects include developing and enhancing green spaces.						Sustainability Office (SO)/Environmental Sustainability Team (EST)	N/A	24/25 - In progress as part of Public Realm Proposals and habitat enhancement will be required under Biodiversity Net Gain for construction projects (e.g. GMIoT).
<b><i>Biodiversity, Landscape and Heritage</i></b>	Confirm target species and develop specific plans						Environmental Sustainability Team (EST)	N/A	24/25 - Draft list of target bird and bee list developed.
<b><i>Biodiversity, Landscape and Heritage</i></b>	Monitoring of habitats and wildlife present						Environmental Sustainability Team (EST)	N/A	Establish monitoring programme for Spring 2025 focussing on key species below.

									Engage with local groups e.g. GM Bees, Wasps ad Ants and Swift Groups Include baseline ecological survey as part of Public Realm tender.
<b>Community Involvement</b>	Maintain Community Growing Space volunteering group						EST/GMT	As required for maintenance activities	23/24 Group in place but require additional volunteers. 24/25 - Plans to move towards lower maintenance fruit trees.
<b>Community Involvement</b>	Improve activities in Mary Seacole courtyard to encourage health and social outcomes e.g. chess tables						EST/GMT	Budget required.	24/25 Possibility of collaboration with Growing Togetherness. Look at wellbeing centre in central area e.g. yoga / table tennis etc.
<b>Community Involvement</b>	Increase promotion of outdoor spaces for staff development and student engagement.						Environmental Sustainability Team	N/A	23/24 - In progress via Green Campus Group and Community Growing Space. 23/24 - Green Spaces Trail developed and now on website 24/25 - Create video clip using students from Wildlife Documentary MA
<b>Marketing and Communication</b>	Increase student and local community membership of the Green Campus Group						Sustainability Office / Environmental	N/A	In progress; information on Group's activities on the website.

							Sustainability Team (EST)		
<b>Marketing and Communication</b>	Develop Medicinal Herb Trail						Grounds Team and External Partners	Public Realm	Budget has been approved and partnerships developed with Chartered Institute of Horticulture and Get Up & Grow.
<b>Marketing and Communication</b>	Develop video clip of biodiversity on campus						Environmental Sustainability Team	N/A	Partnership established with Wildlife Documentary MA

#### Area Specific Biodiversity Plans

Green Space	Action Plan	20/21	21/22	22/23	23/24	24/25	Owner	Budget	Status (monitoring and evaluation)
<b>Christchurch Orchard</b>	Increase number and range of fruit bearing trees. Let grass grow longer. Look to utilise produce on campus.						Sustainability Office/ Environmental Sustainability Team	Budget required	Discussions have been held with Food and Drink Team. Additional training to be investigated to maximise yield
<b>Willow Ornamental Memorial Garden</b>	Focus on ornamental planting but increasing pollinating plants. Allow hedges to grow and flower. Potential bee nesting area in bare ground (add sand). Introduce bug hotels.						EST/GMT	N/A	

	Add Green Flag sign.								
<b>Chapman Square</b>	Introduce bug habitat under trees e.g. log piles and allow leaf decay. Increase planting to provide more protected areas.						EST/GMT	N/A	
<b>Community Garden</b>	Introduce fruit trees and 'meanwhile' long grass / wildflower area. Monitor potential beetles in tree stump for long horn beetles / stag beetles.						Sustainability Office	Budget required	Discuss mini pond and small compost box. Discussions underway regarding potential funding from Barratt Homes.
<b>Memorial Arboretum</b>	Introduce bird boxes. 'meanwhile' grass areas.						Environmental Sustainability Team	N/A	Work with bird specialists to determine types of boxes.
<b>University Road Wildflower Area</b>	Expand wildflower area onto embankment. Signage on wildflowers.						Grounds Management Team	Budget required	Discussions underway regarding funding to rotavate a strip that demarcates the width of the old canal and plant with arable wildflower mix (poppy, marigold etc)
<b>Strawberry Hill Woodland</b>	Implement Woodland Management Plan. Encourage nettles as good pollinators. Leave dead wood in place. Bluebell planting along Wallness Road						Sustainability Office	Potential funding from Salford City Council	23/24 - Woodland management plan developed and agreed with SCC. Funding potentially in place for bluebell and other forest flower planting.

<b>David Lewis Nature Area</b>	Summer hay meadow cut and pollarding of trees to encourage biodiversity						Grounds Management Team	Potentially Public Realm	23/24 – Pollarding in progress of willow trees in DLPF
<b>Connecting Spaces</b>	Increase pollinating plants in plant boxes. Ensure soil is peat free.						Grounds Management Team	N/A	24/25 – Planters installed entrance driveway to Peel Building.

# Appendix 1 – Closed actions

<b>Green Flag Award criteria</b>	<b>Action</b>	<b>Owner</b>	<b>Status (monitoring and evaluation)</b>
<b><i>A Welcoming Place</i></b>	Improve path (adjacent to Wallness Lane) and entrance (from Frederick Rd) at David Lewis Playing Fields so that they are more accessible.	GMT	Completed as part of the 3G pitch.
<b><i>A Welcoming Place</i></b>	Review results from community survey and investigate potential for interpretation onsite.	EST/GMT	Completed; superseded by ongoing engagement, e.g. Green Campus Group.
<b><i>A Welcoming Place</i></b>	Improve signage at David Lewis Playing Fields.	GMT/EST	New signage installed for the 3G pitch
<b><i>Healthy, Safe and Secure</i></b>	Monitor dog waste at David Lewis and install more bins if required.	GMT	No issues raised currently and no comments / complaints over 2023.
<b><i>Well Maintained and Clean</i></b>	Monitor cigarette contamination in Gumdrop bins and run campaign to reduce as required	EST	Ongoing monitoring of the bins. No issues raised over 2023.
<b><i>Environmental Management</i></b>	IGNITION project phase 1: Rain Garden	IGNITION/UoS	Completed in 2020 – monitoring within research.
<b><i>Environmental Management</i></b>	IGNITION project phase 2: Green Roof, Living Lab and SUDS trees	IGNITION/UoS	Completed in 2021 – monitoring within research.
<b><i>Environmental Management</i></b>	Achieve and maintain Platinum EcoCampus ISO 14001 and ISO 50001 certifications	EST	Achieved 2019.
<b><i>Environmental Management</i></b>	Move to battery powered landscaping machinery	GMT	In place: electric mover, chainsaw, leaf blowers, pole saw, hedge cutter, cut off saw, EVs, electric golf carts and battery powered road sweeper.
<b><i>Environmental Management</i></b>	Review use of pesticides and aim to reduce	GMT	2018/19 decrease of 66%. Currently at minimum, only administered by certified individuals with PA1/6 training.

<b>Biodiversity, Landscape and Heritage</b>	Work with Peel Park to run a BioBlitz event to gain species survey information	EST	Completed in March 2022 and 2023.
<b>Biodiversity, Landscape and Heritage</b>	Hedgehog Friendly Campus: achieve Silver award.	EST	Achieved in January 2022.
<b>Biodiversity, Landscape and Heritage</b>	Hedgehog Friendly Campus: achieve Gold award.	EST	Achieved in January 2023.
<b>Biodiversity, Landscape and Heritage</b>	Install bird boxes at David Lewis Playing Field	EST	Blue tit boxes installed as part of a research project.
<b>Biodiversity, Landscape and Heritage</b>	Install bird and bat boxes	EST	Bat and swift boxes installed as part of the Z House Project. Bird boxes also installed as part of the Ignition Project.
<b>Biodiversity, Landscape and Heritage</b>	Install insect habitats e.g. bug hotels, bee hives etc.	EST	Bug hotels installed on Ignition Living Wall. 4 beehives and 2 insect hotels as part of the Community Growing Space). Further beehives used for research (behind faith centre).
<b>Biodiversity, Landscape and Heritage</b>	Wildflower areas	GMT	Established on the bank at the side of Mary Seacole and wildflower patches at the Community Growing Space.
<b>Biodiversity, Landscape and Heritage</b>	Hedgehog friendly campus Platinum Award.	SO	Achieved
<b>Community Involvement</b>	Develop Stages 1 & 2 of the Tree Trail: online information, PDF map, signage.	EST	Completed. Designated webpage and PDF map developed in collaboration with School of Arts & Media students and Marketing department. Signage developed with students, Maker Space, Peel Park team and Landscape Team.
<b>Community Involvement</b>	Repair, maintain and develop Newton greenhouse space	Maker Space	Work completed.
<b>Community Involvement</b>	Launch Community Growing Space	EST	Completed in June 2022.

<b><i>Community Involvement</i></b>	IGNITION project stakeholder and community engagement	IGNITION/EST	IGNITION Living Lab project ended in April 2022.
<b><i>Marketing and Communication</i></b>	Update and improve the information on the Estates & Facilities and Environmental Sustainability webpages related to outside spaces.	EST	Environmental Sustainability webpages are live, with an up-to-date Biodiversity and Landscape Management page.

---

## Appendix 2 – Links and screenshots

Links to recent articles related to the Green Flag Award and biodiversity and landscape management:

- *University of Salford named as one of the best green spaces in the UK for fifth year running* (University News Hub)  
<https://www.salford.ac.uk/news/university-of-salford-named-as-one-of-the-best-green-spaces-in-the-uk-for-fifth-year-running>
- Green Flag Awards 2024 ([Environmental Sustainability blog](#))
- BioBlitz – Go Green Salford 2024 ([Environmental Sustainability blog](#))
- HFC Platinum Project Round Up 2023-2024 ([Environmental Sustainability blog](#)) Salford ranked in top ten of UK University 'green' league ([University News Hub](#))
- Sustainable Salford up for five gongs at the 2024 green gown awards ([University News Hub](#))
- Go Green Salford 2025 ([University website](#))

Screenshots of recent social media posts related to the Green Flag Award, and biodiversity and landscape management:

This is an image of 18 – 25 year olds sharing their opinion on the Greater Manchester nature strategy, hosted in the old fire station January 2025.

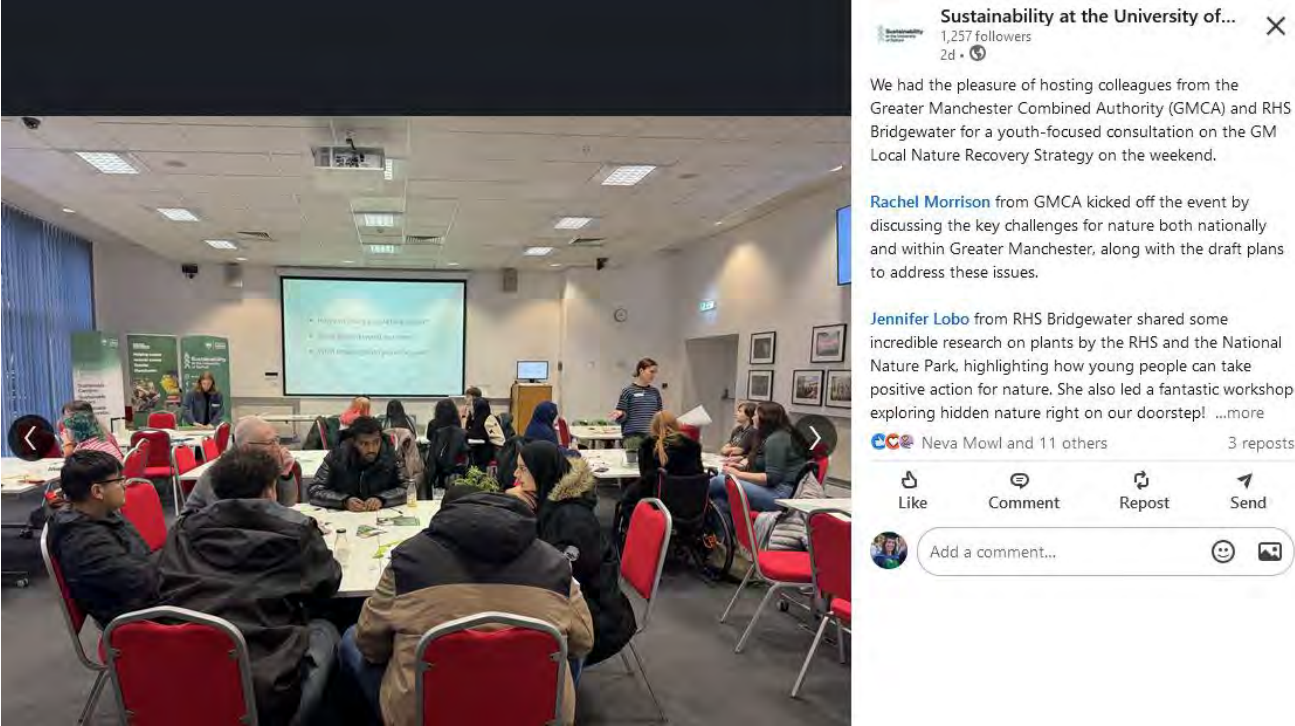

We had someone from Climate Clarity charity teach members of our team and university staff about biodiversity through a card game workshop.

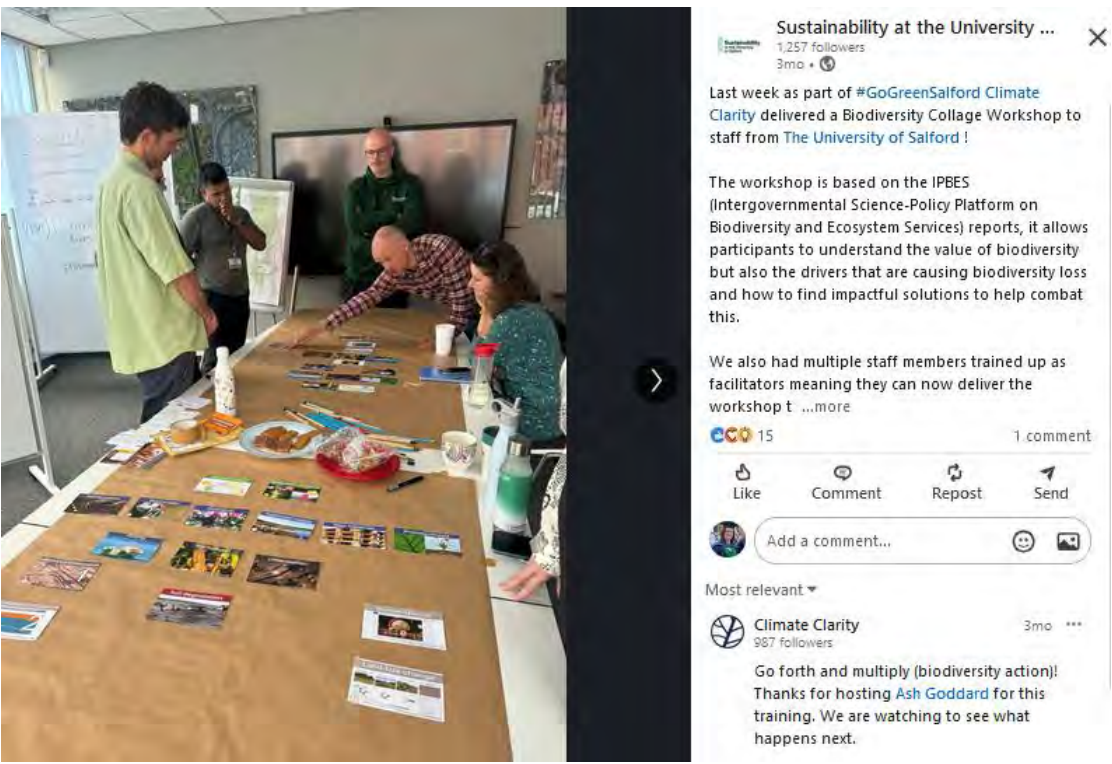

In September 2024 there was a “Pedal powered family fun day” event on Peel Campus.



Last August two members of our team attended the Green Flag Awards to collect our certificate.



In collaboration with Mersey Rivers Trust there was a river sampling event in the River Irwell and they found Stickleback, Freshwater Shrimp, and Hoverfly larvae.



Members of the university had the chance to build their very own hedgehog house.



An article on biodiversity improvements on campus with published on the University Linked-In page in January 2025



The University of Salford

181,481 followers

3d • 

...

We are proud to have one of the best green campuses in the UK. Providing green space for our students, staff and the local community and provides opportunities for socialising, improving physical and mental wellbeing and enjoying nature. In ...more



 James Patterson and 283 others

7 comments · 5 reposts

 Like

 Comment

 Repost

 Share