

Connecting an Android device to the UoS-WiFi Service

Connecting a Google Android device to the UoS-WiFi Service

The University of Salford has added a seamless way to connect your devices to the wireless network available on campus; this user guide will provide instructions on how to connect an Android phone or tablet using the new method. Using this method of connecting will allow your device to seamlessly authenticate whenever it is in range of the wireless service on campus, avoiding the need to constantly enter your username and password into a webpage.

Please note that android platforms may vary. These instructions use android version 5.0.2

Connecting to the UoS-WiFi service:

- From your phones home screen find and press the settings icon



- On your **Settings** menu navigate to and press the **Wi-Fi** option

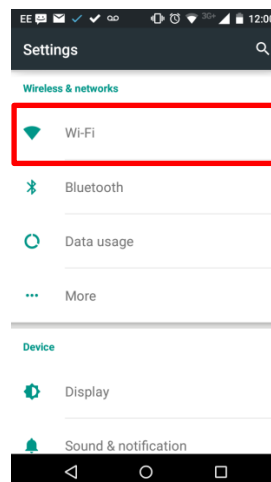

- Your phone will search for all available Wi-Fi networks within range. Once completed select the network named **UoS-WiFi**

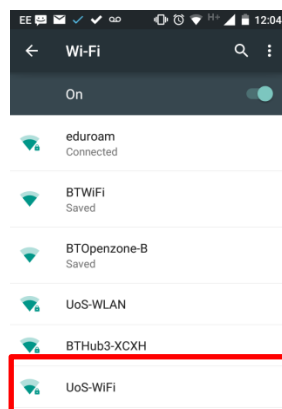

- You will be prompted to enter some details, please populate the following fields:

Phase 2 authentication - **MSCHAPv2**
CA Certificate - **(Unspecified)**

****Note for Android 7 and above this has changed to Do Not Validate****



Identity - **Your UoS ID e.g. abc123**
Anonymous identity - **Leave Blank**
Password - **Your UoS Password**

Example:

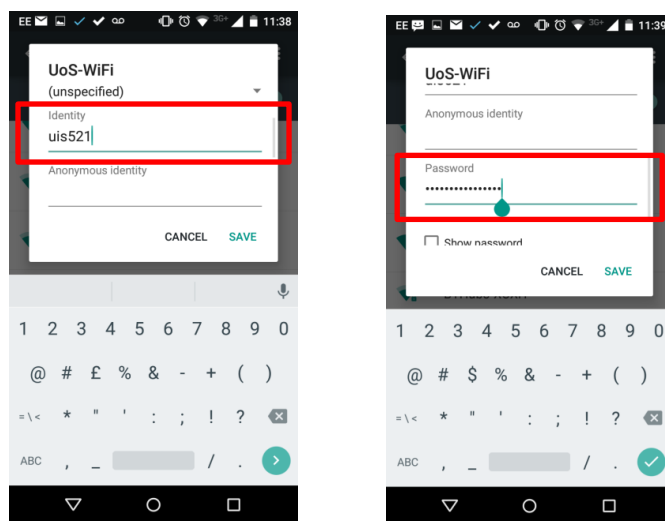

- Click **Connect**. You will be taken back to the list of available networks. The network UoS-WiFi should be top of the list where it will cycle through a state of **connecting...** and **connected**

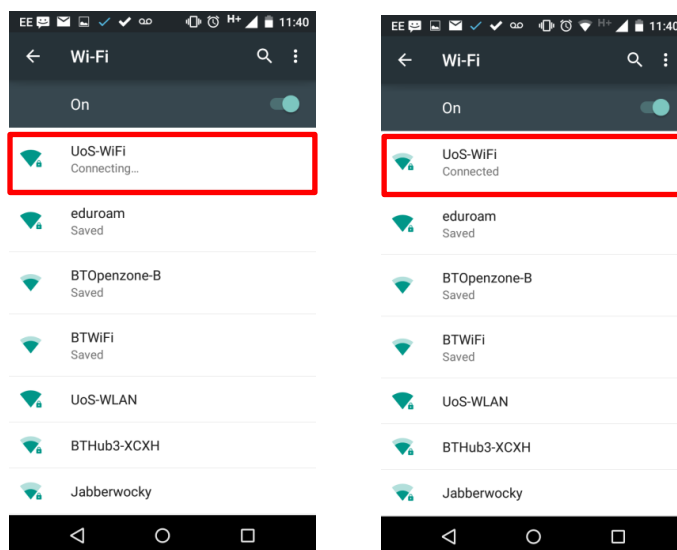

- You are now connected to the UoS-WiFi wireless service.