

Graduate sooner with an Accelerated Degree .

the swift way to a career in the built environment

University of
Salford
MANCHESTER

SoBE
School of Built Environment

Accelerate your career in the Built Environment .

Our new Accelerated degree pathway allows you to complete your undergraduate programme in just 24 months.

You will study the same content as the three year course but your accelerated degree will make full use of the academic year. You study during the summer months and you could progress to a Masters programme more quickly than others in your industry. Accelerated degrees can demonstrate your determination to potential employers and help you to enter the job market faster than a traditional degree route.

Accelerated options for full-time degrees:

The accelerated degree option allows you to complete your programme in 24 months over 6 trimesters.

You will be able to study the following degrees as an Accelerated degree option:

- BSc (Hons) Architectural Design & Technology
- BSc (Hons) Building Surveying
- BSc (Hons) Construction Project Management
- BSc (Hons) Quantity Surveying
- BSc (Hons) Property & Real Estate

Why choose an Accelerated degree option?

Accelerated study is a different option for undergraduates. It uses all three trimesters of the academic year (autumn, spring, and summer), rather than just two (autumn and spring). Accelerated study allows you to study at a more intense rate. If you are dedicated and wish to start your career sooner, choose the trimester study option.

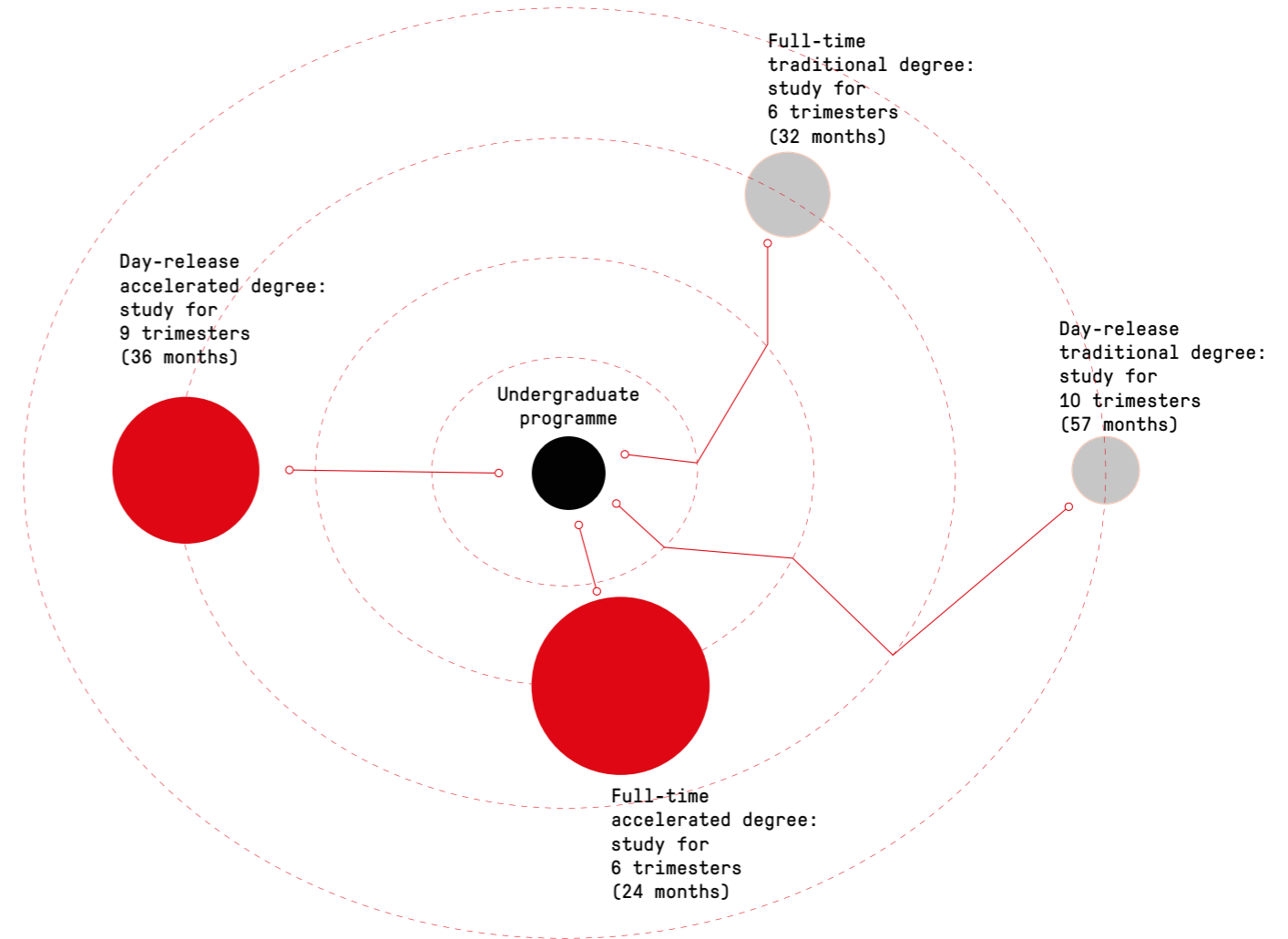

How does accelerated study work?

Want to study on day release?

There are two different options. Traditional day release allows you to complete your programme over 5 years, and includes summer breaks. Alternatively, accelerated day release uses the summer trimester and permits completion in just 3 years, giving you a chance to progress much quicker in your career.

What does accelerated study mean for day release students?

Accelerated, day-release study uses all three trimesters of the academic year (autumn, spring, and summer), rather than just two (autumn and spring).

Accelerated day-release study also allows you to study at a more intense rate, so if you are ambitious and wish to support your career development, choose trimester study with the School of the Built Environment.

Accelerated options for day-release degrees:

You will be able to study:

- BSC (Hons) Architectural Design & Technology
- BSC (Hons) Building Surveying
- BSC (Hons) Construction Project Management
- BSC (Hons) Quantity Surveying
- BSC (Hons) Property & Real Estate

By choosing to take the accelerated study option you will still learn on campus with other students during the standard academic year. You will use the summer time to continue to be taught lectures, to study with full access to our superb library and IT facilities, and our Blackboard Virtual Learning Environment. You will also have the support of your academic tutors and professional support staff.

What will you gain with accelerated study?

You will be able to progress with your career or postgraduate study sooner than you would using the traditional pathway. On the accelerated full time programme you'll only have to plan for two years of full-time tuition fees and living expenses. This adds up to a significant saving when compared to a traditional three year degree. If you are successful with a government living cost loan, you'll only need financial support for two years.

On the accelerated day release study option, you will complete your degree in 36 months fully two years earlier than on the traditional 5 year pathway, thereby saving you time and money, and supporting your career development.

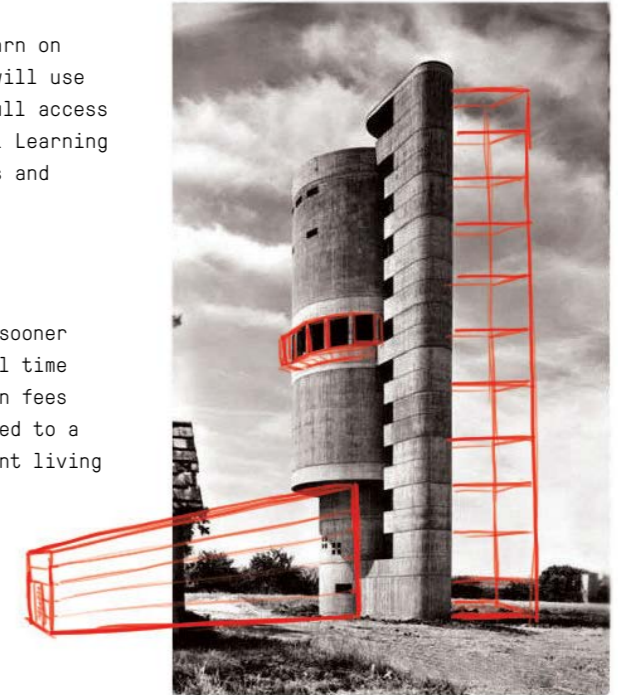

See how the savings add up .

- Traditional three-year degree
- Accelerated degree
- Savings made by taking the accelerated degree

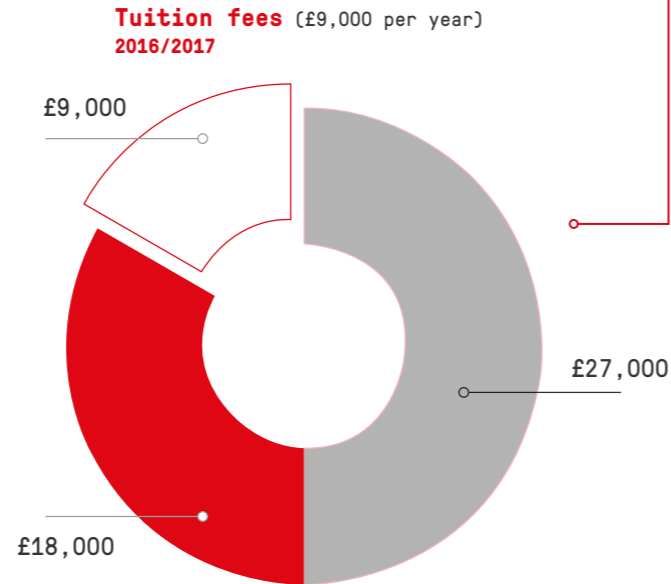

Living costs (maintenance loan) -
living away from home outside of London*



Cost & savings



*Savings based on Maintenance Loan Living Costs, England (www.gov.uk/student-finance/new-fulltime-students)

Example Trimester Study Calendar .

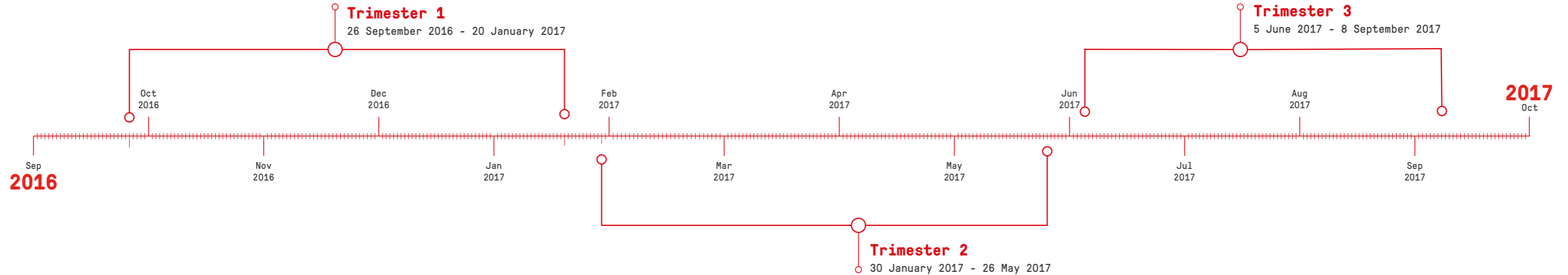

Three study periods during the teaching year.

*Christmas and Easter vacation periods remain the same for all students.

What people from industry say:

The University of Salford are clearly demonstrating that they are responding to the changing learning requirements of today's construction industry.

John Williamson, Redrow Homes Ltd

About the School of the Built Environment .

The School of the Built Environment (SoBE) aims to transform the quality of life for society whilst ensuring the wellbeing of future generations through the provision of better and more sustainable urban futures. We engage in quality, advanced, cutting-edge, and impactful education and research in the built and human environment. The School is motivated around the industry, society and communities.

The School of the Built Environment (SoBE) is a top rated school in the national Research Assessment Exercises and has been a leader in the industry's research agenda for more than 20 years. In addition to this, SoBE recently continued its leading position in the QS World Ranking list of the world's top 50 universities, after the prestigious international university rankings organisation Quacquarelli Symonds (QS) placed the School 46th in the World and 6th in the UK for Architecture/ Built Environment. These rankings highlight the world's top universities in 42 individual subjects based on academic reputation and research impact.



For more information, please visit
www.salford.ac.uk/built-environment